

SU3 Sanitary Gauges

Outline

This pressure gauge is specially designed to be used for pressure measuring in a variety of fields where hygiene is taking into consideration, such as food, medicine, cosmetics and biology.

Features

- Uses a stainless steel diaphragm.
- Case protective construction: IP65
- The radiation tube type excels in endurance and external detergency.



1S Ferrule wetted parts



The diaphragm is optimized for the inside diameter of ISO (IDF) 1S pipes, keeping contamination to a bare minimum through optimal fitting.



Diaphragm diameter: φ23





Radiation shape

Selectable radiation shapes from expanded lineup to accommodate variety of operating temperature environments.

| Radiation shape | | Standard | Radiation fin | Radiation tube |
|-----------------------------|--------------|---|--|---|
| Externals | |  |  |  |
| | | SU31 | SU33 | SU3E |
| Operating temperature range | Wetted parts | -5 to 100°C | -5 to 135°C | |
| | Ambient | | -5 to 40°C | |
| Allowable temperature range | Wetted parts | | -5 to 150°C | |
| | Ambient | | -5 to 60°C | |

Mounting type

Available with selectable mounting types for variety of applications allows for space-saving.

| Stem type | | | Back type* | |
|---|---|---|--|---|
| A-frame | A-frame, Radiation fin shape | A-frame, Radiation tube shape | DA-frame | DA-frame, Radiation fin shape |
|  |  |  |  |  |

* The shape of the radiation tube cannot be manufactured.

Specifications

| Radiation shape | Standard | | | | Radiation fin | | | | Radiation tube | | |
|------------------------------|---|--------------------------------|---------|----------|----------------------|----------|---------|----------|---|-------|--|
| Size | φ 75 | | φ 100 | | φ 75 | | φ 100 | | φ 75 | φ 100 | |
| Model | SU30 | SU35 | SU31 | SU36 | SU32 | SU37 | SU33 | SU38 | SU3C | SU3E | |
| Shape | A-frame | DA-frame | A-frame | DA-frame | A-frame | DA-frame | A-frame | DA-frame | A-frame | | |
| Accuracy | ± 1.5% F.S. at 23°C | | | | | | | | | | |
| Wetted parts material | Diaphragm | SUS316L | | | | | | | | | |
| | Fitting | SUS316 or SUS316L (selectable) | | | | | | | | | |
| Pressure range | 0 to 0.1 → 0 to 5MPa -0.1 to 0 → 0.1 to 2MPa | | | | | | | | | | |
| Temperature coefficient | Mounting periphery | | | | 0.2% F.S./°C or less | | | | | | |
| | Wetted parts | | | | 0.1% F.S./°C or less | | | | | | |
| Filled liquid | Propylene glycol (Vacuum, Compound gauge: Silicone oil) | | | | | | | | | | |
| Case material | SUS304 (electropolished) | | | | | | | | | | |
| Glass | Inorganic glass or organic glass | | | | | | | | | | |
| Needle clamp | Nil | | | | | | | | | | |
| Zero-adjustable pointer | With II-type Zero-adjustable pointer (Spring type) | | | | | | | | With I-type Zero-adjustable pointer (Gear type) | | |
| Vent plug*1 | 0.3MPa or less | | | | | | | | | | |
| Case protection construction | IP65*2 | | | | | | | | | | |

*1 To prevent errors caused by internal pressure, please make sure to raise the vent plug when measuring pressure.

*2 When the range is 0.3MPa or less, it will be IP65 when the vent plug is lowered.

Dimensions 1

(Ferrule type)

[Standard shape]

φ 100

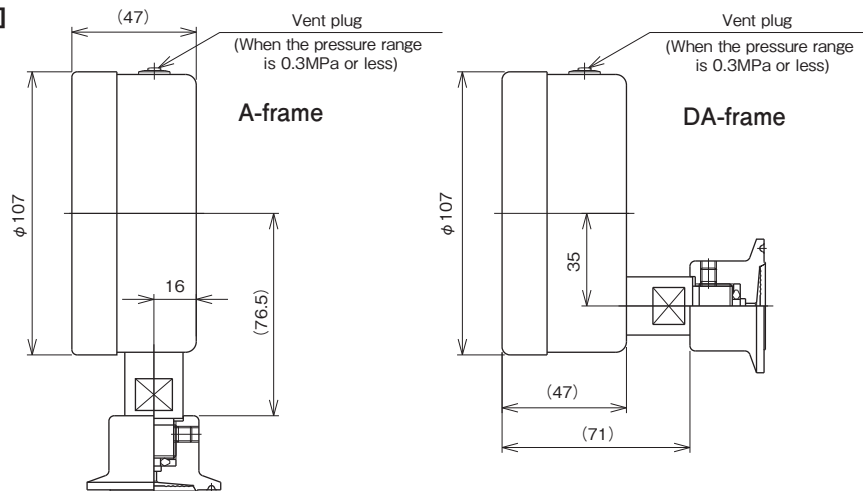

Dimensions 2

(Ferrule type)

[Standard shape]

φ75

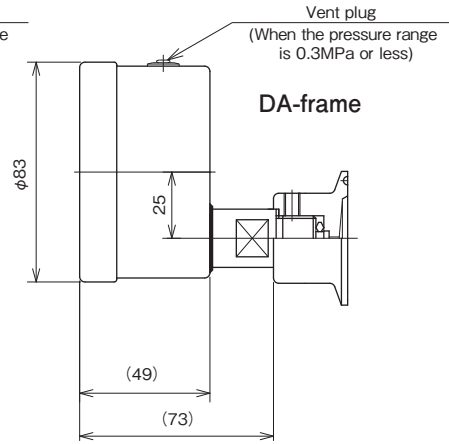
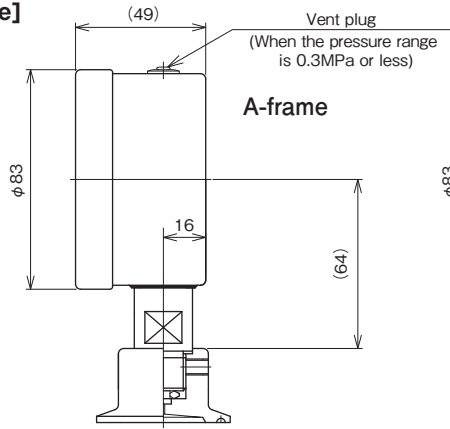

[Radiation fin shape]

φ100

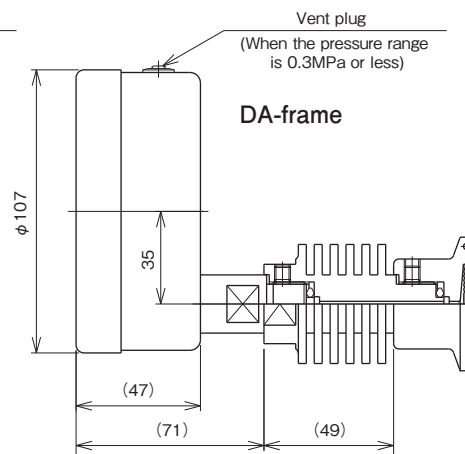
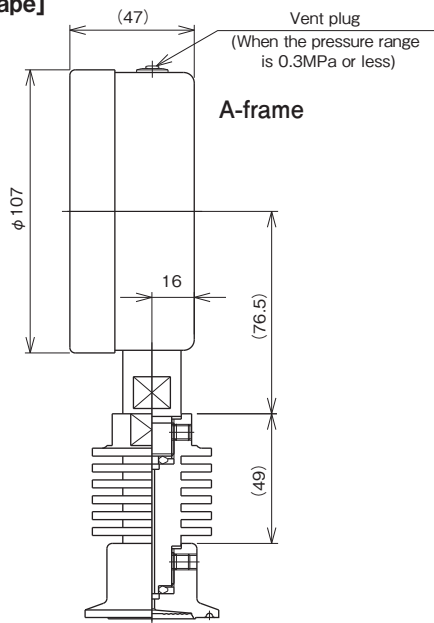

φ75

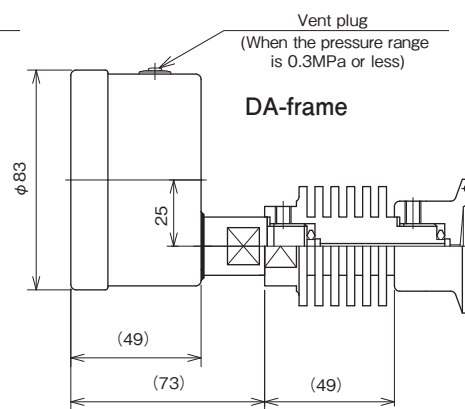
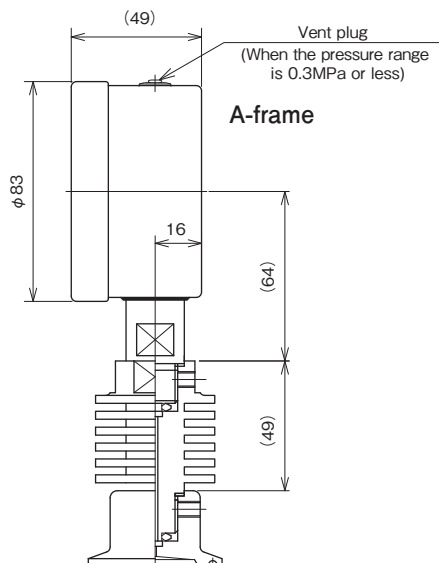

Dimensions 3 (Ferrule type)

[Radiation tube shape]
 $\phi 100$ (A-frame only)

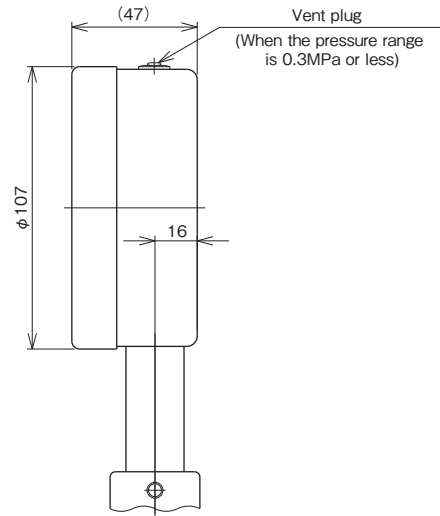
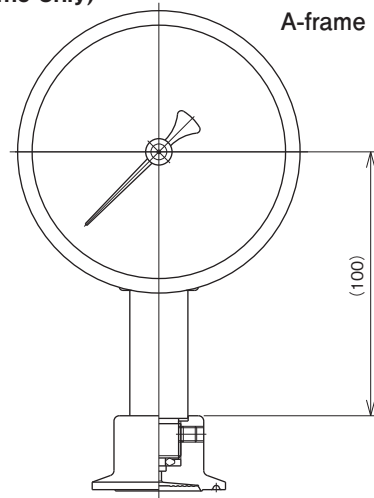

$\phi 75$ (A-frame only)

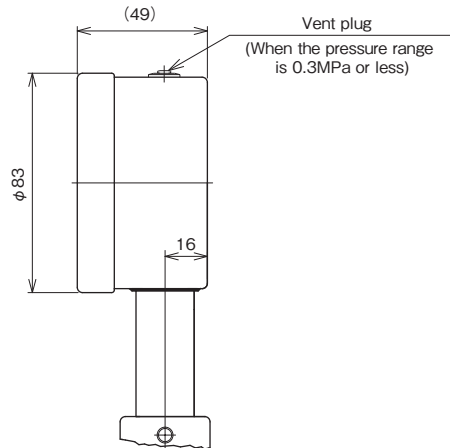
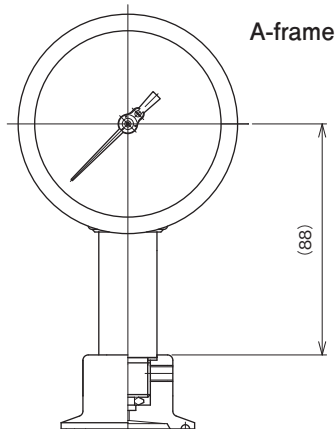

Dimensions 4

[Connection type]

Ferrule type

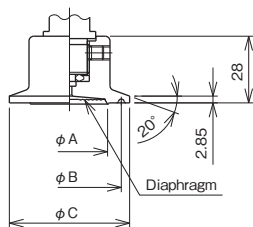

| Ferrule size | A | B | C |
|--------------|----|------|------|
| 1S | 23 | 43.5 | 50.5 |
| 1 1/2S | 32 | 43.5 | 50.5 |
| 2S | 47 | 56.5 | 64 |

ISO (IDF) Standard

Nut type

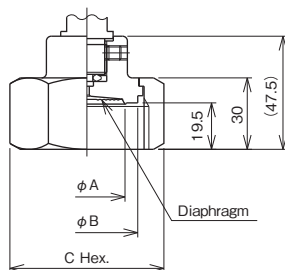

| Nut size | A | B | C |
|----------|----|------|---------|
| 1 1/2S | 32 | 42.7 | 56x64.7 |
| 2S | 47 | 56.2 | 71x82 |

ISO (IDF) Standard

Male type

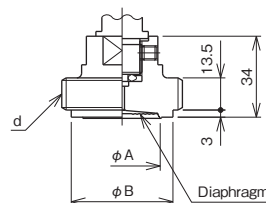

| Thread size d | A | B |
|------------------|----|------|
| 1 1/2S | 32 | 42.7 |
| 2S | 47 | 56.2 |

ISO (IDF) Standard

Universal thread type

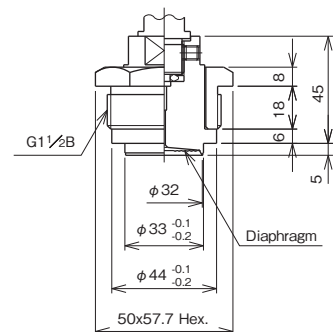

(ϕ 100) Standard, Radiation fin shape

Model number configuration

Please specify the model number, each specs and the range for ordering.

| | | | | | | | | | | | | | | | | | |
|---|---------------|---|-----------------|---|---|-----------------|---|---|---------------------------|---|---|--------------------|---|-----------------------|---|---|---|
| Model | | | | | | | | | | | | | | | | | |
| S | U | 3 | | | | | 0 | X | | X | X | X | X | X | X | X | |
| Sanitary Gauges | | | ① | ② | ③ | ④ | ⑤ | ⑥ | ⑦ | ⑧ | ⑨ | ⑩ | ⑪ | ⑫ | ⑬ | ⑭ | ⑮ |
| Model number | | | | | | Selective spec. | | | Additional spec. (Option) | | | | | | | | |
| Case | 3 | Stainless Steel (SUS304) | | | | | | | | | | | | | | | |
| Shape | Size | Frame | Radiation shape | | | | | | | | | | | | | | |
| | 1 | A-frame | Standard | | | | | | | | | | | | | | |
| | 3 | | Radiation fin | | | | | | | | | | | | | | |
| | 6 | DA-frame | Standard | | | | | | | | | | | | | | |
| 8 | Radiation fin | | | | | | | | | | | | | | | | |
| ① Connection type *1 | 1 | Ferrule type (Please use within proofpressure of the clamp and gasket) | | | | | | | | | | | | | | | |
| | 2 | Nut type | | | | | | | | | | | | | | | |
| | 3 | Male type | | | | | | | | | | | | | | | |
| | 4 | Universal thread type ②③ G1½B only | | | | | | | | | | | | | | | |
| ② Connection size | 2 | 1S (Only Ferrule type can be manufactured) | | | | | | | | | | | | | | | |
| | 3 | 1½S or G1½B (Only universal thread type can be manufactured with G1½B) | | | | | | | | | | | | | | | |
| | 4 | 2S | | | | | | | | | | | | | | | |
| | 5 | 2½S | | | | | | | | | | | | | | | |
| | 6 | 3S | | | | | | | | | | | | | | | |
| ③ Wetted parts material *2 | 3 | SUS316 | | | | | | | | | | | | | | | |
| | 4 | SUS316L | | | | | | | | | | | | | | | |
| | 5 | SUS316 Buff finish (Universal thread type cannot be manufactured) | | | | | | | | | | | | | | | |
| | 6 | SUS316L Buff finish (Universal thread type cannot be manufactured) | | | | | | | | | | | | | | | |
| ④ Pressure range (MPa) | 1 | -0.1 to 0.6, 1, 1.5, 2 Compound gauge | | | | | | | | | | | | For ② size 2 | | | |
| | | -0.1 to 0.2, 0.3, 0.4, 0.5, 0.6, 1, 1.5, 2 Compound gauge | | | | | | | | | | | | For ② size 3 | | | |
| | | -0.1 to 0.1, 0.2, 0.3, 0.4, 0.5, 0.6, 1, 1.5, 2 Compound gauge | | | | | | | | | | | | For ② size 4, 5 and 6 | | | |
| | 2 | 0 to 0.6, 1, 1.5, 2, 2.5, 3.5 | | | | | | | | | | | | For ② size 2 | | | |
| | | 0 to 0.2, 0.3, 0.4, 0.5, 0.6, 1, 1.5, 2, 2.5, 3.5, 5 (5MPa Ferrule cannot be manufactured) | | | | | | | | | | | | For ② size 3 | | | |
| | | 0 to 0.1, 0.2, 0.3, 0.4, 0.5, 0.6, 1, 1.5, 2, 2.5, 3.5, -0.1 to 0 | | | | | | | | | | | | For ② size 4 | | | |
| 0 to 0.1, 0.2, 0.3, 0.4, 0.5, 0.6, 1, 1.5, 2, -0.1 to 0 | | | | | | | | | | | | For ② size 5 and 6 | | | | | |
| ⑤ Accuracy | 0 | Standard (\pm 1.5%F.S.) | | | | | | | | | | | | | | | |
| ⑦ Glass | 0 | Inorganic glass | | | | | | | | | | | | | | | |
| | 1 | Organic glass (Acrylic) | | | | | | | | | | | | | | | |
| ⑮ Documents | 0 | Nil | | | | | | | | | | | | | | | |
| | 1 | Required (Please specify the desired documents separately.) Submission drawings, instruction manual, inspection procedure, mill sheet, test report (1 pc 1 copy), inspection / traceability certificate, attended inspection | | | | | | | | | | | | | | | |

Please specify the pressure range and units separately besides selection of range code.

⚠ Cautions

- *1 Please use it within the range of proofpressure of connected parts (clamp, nut, and gasket, etc.). When using Ferrule types, many commercial clamps have a pressure resistance of 1MPa or less. Please keep the pressure at 1MPa or less as long as you are not using special-purpose items.

[Manufacturing range]

- Filled liquid: Propylene glycol (Vacuum, Compound gauge: Silicone oil)
- Wetted parts material: Diaphragm: SUS316L, Fitting: SUS316 or SUS316L
- *2 Please contact us for electrolytic polishing wetted parts and passivation treatment specifications.

*Parts required for installation, such as clamps, nuts, gaskets, etc., are to be prepared by the user.

* Specify "X" if there is no specification item.

(ϕ 100) Radiation tube shape

Model number configuration

Please specify the model number, each specs and the range for ordering.

| | | | | | | | | | | | | | | | | | | | | | | | | | | | | | | | | | | | | | | | | | | | | | | | |
|---|---|--------------------------|------------|---|---|-----------------|----------------|---|---|---|---|---|--|---|---|---|---|---|---|---|---|---|---|---|---|---|---|--|---|--|---|--|---|--|---|--|---|--|---|--|---|--|---|--|---|--|---|
| Model | | Sanitary Gauges | | | <table border="1"> <tr> <td>④</td><td>0</td><td>×</td><td>×</td><td>×</td><td>×</td><td>×</td><td>×</td><td>×</td><td>×</td><td>×</td><td>×</td> </tr> <tr> <td>⑤</td><td></td><td>⑥</td><td></td><td>⑦</td><td></td><td>⑧</td><td></td><td>⑨</td><td></td><td>⑩</td><td></td><td>⑪</td><td></td><td>⑫</td><td></td><td>⑬</td><td></td><td>⑭</td><td></td><td>⑮</td> </tr> </table> | | | | | | | | | | ④ | 0 | × | × | × | × | × | × | × | × | × | × | ⑤ | | ⑥ | | ⑦ | | ⑧ | | ⑨ | | ⑩ | | ⑪ | | ⑫ | | ⑬ | | ⑭ | | ⑮ |
| ④ | 0 | × | × | × | × | × | × | × | × | × | × | | | | | | | | | | | | | | | | | | | | | | | | | | | | | | | | | | | | |
| ⑤ | | ⑥ | | ⑦ | | ⑧ | | ⑨ | | ⑩ | | ⑪ | | ⑫ | | ⑬ | | ⑭ | | ⑮ | | | | | | | | | | | | | | | | | | | | | | | | | | | |
| Model number | | Selective spec. | | | Additional spec. (Option) | | | | | | | | | | | | | | | | | | | | | | | | | | | | | | | | | | | | | | | | | | |
| Case | 3 | Stainless Steel (SUS304) | | | | | | | | | | | | | | | | | | | | | | | | | | | | | | | | | | | | | | | | | | | | | |
| Shape | E | Size | ϕ 100 | Frame | A-Frame | Radiation shape | Radiation tube | | | | | | | | | | | | | | | | | | | | | | | | | | | | | | | | | | | | | | | | |
| | ① | Connection type *1 | 1 | Ferrule type (Please use within proofpressure of the clamp and gasket) | | | | | | | | | | | | | | | | | | | | | | | | | | | | | | | | | | | | | | | | | | | |
| | | | 2 | Nut type | | | | | | | | | | | | | | | | | | | | | | | | | | | | | | | | | | | | | | | | | | | |
| | ② | Connection size | 2 | 1S (Only Ferrule type can be manufactured) | | | | | | | | | | | | | | | | | | | | | | | | | | | | | | | | | | | | | | | | | | | |
| | | | 3 | 1½S | | | | | | | | | | | | | | | | | | | | | | | | | | | | | | | | | | | | | | | | | | | |
| | | | 4 | 2S | | | | | | | | | | | | | | | | | | | | | | | | | | | | | | | | | | | | | | | | | | | |
| | ③ | Wetted parts material *2 | 3 | SUS316 | | | | | | | | | | | | | | | | | | | | | | | | | | | | | | | | | | | | | | | | | | | |
| | | | 4 | SUS316L | | | | | | | | | | | | | | | | | | | | | | | | | | | | | | | | | | | | | | | | | | | |
| | | | 5 | SUS316 Buff finish | | | | | | | | | | | | | | | | | | | | | | | | | | | | | | | | | | | | | | | | | | | |
| | | | 6 | SUS316L Buff finish | | | | | | | | | | | | | | | | | | | | | | | | | | | | | | | | | | | | | | | | | | | |
| Please specify the pressure range and units separately besides selection of range code. | ④ | Pressure range (MPa) | 1 | -0.1 to 0.6, 1, 1.5, 2 Compound gauge For ② size 2 | | | | | | | | | | | | | | | | | | | | | | | | | | | | | | | | | | | | | | | | | | | |
| | | | | -0.1 to 0.2, 0.3, 0.4, 0.5, 0.6, 1, 1.5, 2 Compound gauge For ② size 3 | | | | | | | | | | | | | | | | | | | | | | | | | | | | | | | | | | | | | | | | | | | |
| | | | | -0.1 to 0.1, 0.2, 0.3, 0.4, 0.5, 0.6, 1, 1.5, 2 Compound gauge For ② size 4 | | | | | | | | | | | | | | | | | | | | | | | | | | | | | | | | | | | | | | | | | | | |
| | | | 2 | 0 to 0.6, 1, 1.5, 2, 2.5, 3.5 For ② size 2 | | | | | | | | | | | | | | | | | | | | | | | | | | | | | | | | | | | | | | | | | | | |
| | | | | 0 to 0.2, 0.3, 0.4, 0.5, 0.6, 1, 1.5, 2, 2.5, 3.5, 5 (5MPa Ferrule cannot be manufactured) For ② size 3 | | | | | | | | | | | | | | | | | | | | | | | | | | | | | | | | | | | | | | | | | | | |
| | | | | 0 to 0.1, 0.2, 0.3, 0.4, 0.5, 0.6, 1, 1.5, 2, 2.5, 3.5, -0.1 to 0 For ② size 4 | | | | | | | | | | | | | | | | | | | | | | | | | | | | | | | | | | | | | | | | | | | |
| | ⑤ | Accuracy | 0 | Standard (\pm 1.5%F.S.) | | | | | | | | | | | | | | | | | | | | | | | | | | | | | | | | | | | | | | | | | | | |
| | ⑦ | Glass | 0 | Inorganic glass | | | | | | | | | | | | | | | | | | | | | | | | | | | | | | | | | | | | | | | | | | | |
| | | | 1 | Organic glass (Acrylic) | | | | | | | | | | | | | | | | | | | | | | | | | | | | | | | | | | | | | | | | | | | |
| | ⑮ | Documents | 0 | Nil | | | | | | | | | | | | | | | | | | | | | | | | | | | | | | | | | | | | | | | | | | | |
| | | | 1 | Required (Please specify the desired documents separately.) Submission drawings, instruction manual, inspection procedure, mill sheet, test report (1 pc 1 copy), inspection / traceability certificate, attended inspection | | | | | | | | | | | | | | | | | | | | | | | | | | | | | | | | | | | | | | | | | | | |

⚠ Cautions

- *1 Please use it within the range of proofpressure of connected parts (clamp, nut, and gasket, etc.). When using Ferrule types, many commercial clamps have a pressure resistance of 1MPa or less. Please keep the pressure at 1MPa or less as long as you are not using special-purpose items.

[Manufacturing range]

- Filled liquid: Propylene glycol (Vacuum, Compound gauge: Silicone oil)
- Wetted parts material: Diaphragm: SUS316L, Fitting: SUS316 or SUS316L
- *2 Please contact us for electrolytic polishing wetted parts and passivation treatment specifications.

* Parts required for installation, such as clamps, nuts, gaskets, etc., are to be prepared by the user.

* Specify "X" if there is no specification item.

($\phi 75$) Standard, Radiation fin shape

Model number configuration

Please specify the model number, each specs and the range for ordering.

| | | | | | | | | | | | | | | | | | |
|---|------|---|----------|---------------|---|-----------------|---|---|---------------------------|---|---|--------------------|---|-----------------------|---|---|---|
| Model | | | | | | | | | | | | | | | | | |
| S | U | 3 | | | | | 0 | X | | X | X | X | X | X | X | | |
| Sanitary Gauges | | | ① | ② | ③ | ④ | ⑤ | ⑥ | ⑦ | ⑧ | ⑨ | ⑩ | ⑪ | ⑫ | ⑬ | ⑭ | ⑮ |
| Model number | | | | | | Selective spec. | | | Additional spec. (Option) | | | | | | | | |
| Case | 3 | Stainless Steel (SUS304) | | | | | | | | | | | | | | | |
| Shape | Size | $\phi 75$ | A-frame | Standard | | | | | | | | | | | | | |
| | 0 | | | Radiation fin | | | | | | | | | | | | | |
| | 2 | | DA-frame | Standard | | | | | | | | | | | | | |
| | 5 | | | Radiation fin | | | | | | | | | | | | | |
| 7 | | | | | | | | | | | | | | | | | |
| ① Connection type *1 | 1 | Ferrule type (Please use within proofpressure of the clamp and gasket) | | | | | | | | | | | | | | | |
| | 2 | Nut type | | | | | | | | | | | | | | | |
| | 3 | Male type | | | | | | | | | | | | | | | |
| | 4 | Universal thread type ②③ G1½B only | | | | | | | | | | | | | | | |
| ② Connection size | 2 | 1S (Only Ferrule type can be manufactured) | | | | | | | | | | | | | | | |
| | 3 | 1½S or G1½B (Only universal thread type can be manufactured with G1½B) | | | | | | | | | | | | | | | |
| | 4 | 2S | | | | | | | | | | | | | | | |
| | 5 | 2½S | | | | | | | | | | | | | | | |
| | 6 | 3S | | | | | | | | | | | | | | | |
| ③ Wetted parts material *2 | 3 | SUS316 | | | | | | | | | | | | | | | |
| | 4 | SUS316L | | | | | | | | | | | | | | | |
| | 5 | SUS316 Buff finish (Universal thread type cannot be manufactured) | | | | | | | | | | | | | | | |
| | 6 | SUS316L Buff finish (Universal thread type cannot be manufactured) | | | | | | | | | | | | | | | |
| ④ Pressure range (MPa) | 1 | -0.1 to 0.6, 1, 1.5, 2 Compound gauge | | | | | | | | | | | | For ② size 2 | | | |
| | | -0.1 to 0.2, 0.3, 0.4, 0.5, 0.6, 1, 1.5, 2 Compound gauge | | | | | | | | | | | | For ② size 3 | | | |
| | | -0.1 to 0.1, 0.2, 0.3, 0.4, 0.5, 0.6, 1, 1.5, 2 Compound gauge | | | | | | | | | | | | For ② size 4, 5 and 6 | | | |
| | 2 | 0 to 0.6, 1, 1.5, 2, 2.5, 3.5 | | | | | | | | | | | | For ② size 2 | | | |
| | | 0 to 0.2, 0.3, 0.4, 0.5, 0.6, 1, 1.5, 2, 2.5, 3.5, 5 (5MPa Ferrule cannot be manufactured) | | | | | | | | | | | | For ② size 3 | | | |
| | | 0 to 0.1, 0.2, 0.3, 0.4, 0.5, 0.6, 1, 1.5, 2, 2.5, 3.5, -0.1 to 0 | | | | | | | | | | | | For ② size 4 | | | |
| 0 to 0.1, 0.2, 0.3, 0.4, 0.5, 0.6, 1, 1.5, 2, -0.1 to 0 | | | | | | | | | | | | For ② size 5 and 6 | | | | | |
| ⑤ Accuracy | 0 | Standard ($\pm 1.5\%$ F.S.) | | | | | | | | | | | | | | | |
| ⑦ Glass | 0 | Inorganic glass | | | | | | | | | | | | | | | |
| | 1 | Organic glass (Acrylic) | | | | | | | | | | | | | | | |
| ⑮ Documents | 0 | Nil | | | | | | | | | | | | | | | |
| | 1 | Required (Please specify the desired documents separately.) Submission drawings, instruction manual, inspection procedure, mill sheet, test report (1 pc 1 copy), inspection / traceability certificate, attended inspection | | | | | | | | | | | | | | | |

Please specify the pressure range and units separately besides selection of range code.

⚠ Cautions

- *1 Please use it within the range of proofpressure of connected parts (clamp, nut, and gasket, etc.). When using Ferrule types, many commercial clamps have a pressure resistance of 1MPa or less. Please keep the pressure at 1MPa or less as long as you are not using special-purpose items.

[Manufacturing range]

- Filled liquid: Propylene glycol (Vacuum, Compound gauge: Silicone oil)
- Wetted parts material: Diaphragm; SUS316L, Fitting; SUS316 or SUS316L
- *2 Please contact us for electrolytic polishing wetted parts and passivation treatment specifications.

* Parts required for installation, such as clamps, nuts, gaskets, etc., are to be prepared by the user.

* Specify "X" if there is no specification item.

($\phi 75$) Radiation tube shape

Model number configuration

Please specify the model number, each specs and the range for ordering.

| | | | | | | | | | | | | | | | | | | | | | | | | | | | | | | | | | | | | | | |
|---|---|---|---------|-----------------|--|---|---|--------------|---|--------------|---|--|--|--|---|---|---|---|---|---|---|---|---|---|---|---|---|---|--|---|---|---|---|---|---|---|--|--|
| Model | | Sanitary Gauges | | | <table border="1"> <tr> <td>④</td><td>⑤</td><td>⑥</td><td>⑦</td><td>⑧</td><td>⑨</td><td>⑩</td><td>⑪</td><td>⑫</td><td>⑬</td><td>⑭</td><td>⑮</td> </tr> <tr> <td>0</td><td>X</td><td></td><td>X</td><td>X</td><td>X</td><td>X</td><td>X</td><td>X</td><td>X</td><td></td><td></td> </tr> </table> | | | | | | | | | | ④ | ⑤ | ⑥ | ⑦ | ⑧ | ⑨ | ⑩ | ⑪ | ⑫ | ⑬ | ⑭ | ⑮ | 0 | X | | X | X | X | X | X | X | X | | |
| ④ | ⑤ | ⑥ | ⑦ | ⑧ | ⑨ | ⑩ | ⑪ | ⑫ | ⑬ | ⑭ | ⑮ | | | | | | | | | | | | | | | | | | | | | | | | | | | |
| 0 | X | | X | X | X | X | X | X | X | | | | | | | | | | | | | | | | | | | | | | | | | | | | | |
| Model number | | Selective spec. | | | Additional spec. (Option) | | | | | | | | | | | | | | | | | | | | | | | | | | | | | | | | | |
| Case | 3 | Stainless Steel (SUS304) | | | | | | | | | | | | | | | | | | | | | | | | | | | | | | | | | | | | |
| Shape | C | Size | Frame | Radiation shape | | | | | | | | | | | | | | | | | | | | | | | | | | | | | | | | | | |
| | | $\phi 75$ | A-Frame | Radiation tube | | | | | | | | | | | | | | | | | | | | | | | | | | | | | | | | | | |
| ① Connection type *1 | 1 | Ferrule type (Please use within proofpressure of the clamp and gasket) | | | | | | | | | | | | | | | | | | | | | | | | | | | | | | | | | | | | |
| | 2 | Nut type | | | | | | | | | | | | | | | | | | | | | | | | | | | | | | | | | | | | |
| ② Connection size | 2 | 1S (Only Ferrule type can be manufactured) | | | | | | | | | | | | | | | | | | | | | | | | | | | | | | | | | | | | |
| | 3 | 1½S | | | | | | | | | | | | | | | | | | | | | | | | | | | | | | | | | | | | |
| | 4 | 2S | | | | | | | | | | | | | | | | | | | | | | | | | | | | | | | | | | | | |
| ③ Wetted parts material *2 | 3 | SUS316 | | | | | | | | | | | | | | | | | | | | | | | | | | | | | | | | | | | | |
| | 4 | SUS316L | | | | | | | | | | | | | | | | | | | | | | | | | | | | | | | | | | | | |
| | 5 | SUS316 Buff finish | | | | | | | | | | | | | | | | | | | | | | | | | | | | | | | | | | | | |
| | 6 | SUS316L Buff finish | | | | | | | | | | | | | | | | | | | | | | | | | | | | | | | | | | | | |
| ④ Pressure range (MPa) | 1 | -0.1 to 0.6, 1, 1.5, 2 Compound gauge | | | | | | | | For ② size 2 | | | | | | | | | | | | | | | | | | | | | | | | | | | | |
| | | -0.1 to 0.2, 0.3, 0.4, 0.5, 0.6, 1, 1.5, 2 Compound gauge | | | | | | | | For ② size 3 | | | | | | | | | | | | | | | | | | | | | | | | | | | | |
| | | -0.1 to 0.1, 0.2, 0.3, 0.4, 0.5, 0.6, 1, 1.5, 2 Compound gauge | | | | | | | | For ② size 4 | | | | | | | | | | | | | | | | | | | | | | | | | | | | |
| | 2 | 0 to 0.6, 1, 1.5, 2, 2.5, 3.5 | | | | | | | | For ② size 2 | | | | | | | | | | | | | | | | | | | | | | | | | | | | |
| | | 0 to 0.2, 0.3, 0.4, 0.5, 0.6, 1, 1.5, 2, 2.5, 3.5, 5 (5MPa Ferrule cannot be manufactured) | | | | | | | | For ② size 3 | | | | | | | | | | | | | | | | | | | | | | | | | | | | |
| 0 to 0.1, 0.2, 0.3, 0.4, 0.5, 0.6, 1, 1.5, 2, 2.5, 3.5, -0.1 to 0 | | | | | | | | For ② size 4 | | | | | | | | | | | | | | | | | | | | | | | | | | | | | | |
| ⑤ Accuracy | 0 | Standard ($\pm 1.5\%$ F.S.) | | | | | | | | | | | | | | | | | | | | | | | | | | | | | | | | | | | | |
| ⑦ Glass | 0 | Inorganic glass | | | | | | | | | | | | | | | | | | | | | | | | | | | | | | | | | | | | |
| | 1 | Organic glass (Acrylic) | | | | | | | | | | | | | | | | | | | | | | | | | | | | | | | | | | | | |
| ⑮ Documents | 0 | Nil | | | | | | | | | | | | | | | | | | | | | | | | | | | | | | | | | | | | |
| | 1 | Required (Please specify the desired documents separately.) Submission drawings, instruction manual, inspection procedure, mill sheet, test report (1 pc 1 copy), inspection / traceability certificate, attended inspection | | | | | | | | | | | | | | | | | | | | | | | | | | | | | | | | | | | | |

Please specify the pressure range and units separately besides selection of range code.

⚠ Cautions

- *1 Please use it within the range of proofpressure of connected parts (clamp, nut, and gasket, etc.). When using Ferrule types, many commercial clamps have a pressure resistance of 1MPa or less. Please keep the pressure at 1MPa or less as long as you are not using special-purpose items.

[Manufacturing range]

- Filled liquid: Propylene glycol (Vacuum, Compound gauge: Silicone oil)
- Wetted parts material: Diaphragm: SUS316L, Fitting: SUS316 or SUS316L
- *2 Please contact us for electrolytic polishing wetted parts and passivation treatment specifications.

* Parts required for installation, such as clamps, nuts, gaskets, etc., are to be prepared by the user.

* Specify "X" if there is no specification item.