

SU15

Sanitary Pressure Transmitter

Outline

This sanitary pressure Transmitter uses a stainless steel diaphragm and semiconductor strain gauge for the sensing part. It has been designed/produced to be especially hygienic, so it can be used in a wide variety of fields, such as food products, medical supplies, cosmetics and even bio-related products.

Features

- Excellent durability high vibration-proof and impact resistance to dynamic pressure with the pressure sensor uses a semiconductor strain gauge.
- Stainless steel diaphragm for corrosion resistance, can be used for a wide variety of purposes.
- Stainless steel case makes it easy to wash and drain for sanitary process.
- Possible to select a high pressure proof type for homogenizers.



Specifications

Fluid:

Air or liquid

Operating condition:

Normal conditions (No flammable liquids or explosive gaseous atmospheres)

Connection type:

Ferrule type, Nut type, Male type, Union thread type, and Homogenizer type

Electric cable:

Shielded cable (2 m)

Connection size:

Homogenizer type, 1S, 1½S, 2S, 2½S, 3S, G1½B (Union thread type only)

Wetted parts material:

Diaphragm SUS316L
Joint SUS316 or SUS316L

Pressure range:

0 to 0.3 → 0 to 50MPa
-0.1 to 0.2 → -0.1 to 2MPa

Proof pressure of receiving parts:

2 to 100MPa (Refer to the pressure range chart)

Max. allowable pressure:

Whichever is smaller, the pressure resistance of the receiving part or the double pressure of the positive pressure range.
(However, it's only 1.5 times for the 35, 50 MPa range)

Operating temperature:

-5 to 70°C (Ambient or fittings)

* However, it can be used under temperature up to 135°C for periods of 20 minutes with the ambient temperature is 30°C or lower.

Power source:

24V DC ±10%

Output:

4 to 20mA DC (2-wire) or 1 to 5V DC (3-wire)

Load resistance:

500Ω max. (For current output)
10kΩ min. (For voltage output)

Transmission system:

2-wire or 3-wire

Accuracy:

±1.0% F.S. at 23°C (However, the 50MPa range is ±1.5% F.S. for ranges of 0.3MPa and lower.)

Temperature coefficient:

±0.1% F.S./°C (zero)
±0.1% F.S./°C (span)
(However, the 50MPa range is ±0.15% F.S. for ranges of 0.3MPa and lower.)

Filled liquid:

Propylene glycol (Compound: Silicone oil)

Case materials:

SUS316

Case construction:

Equivalent to IP55 (Except the cable end)

SU15

Sanitary Pressure Transmitter

Dimensions

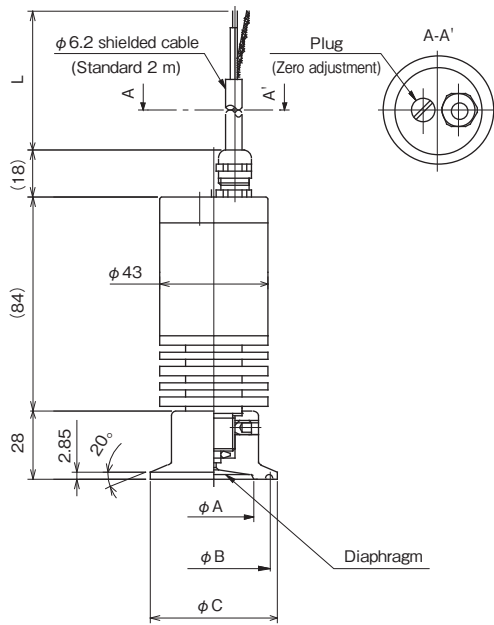

Ferrule type

Ferrule size	A	B	C
1S, 1½S	32	43.5	50.5
2S	47	56.5	64

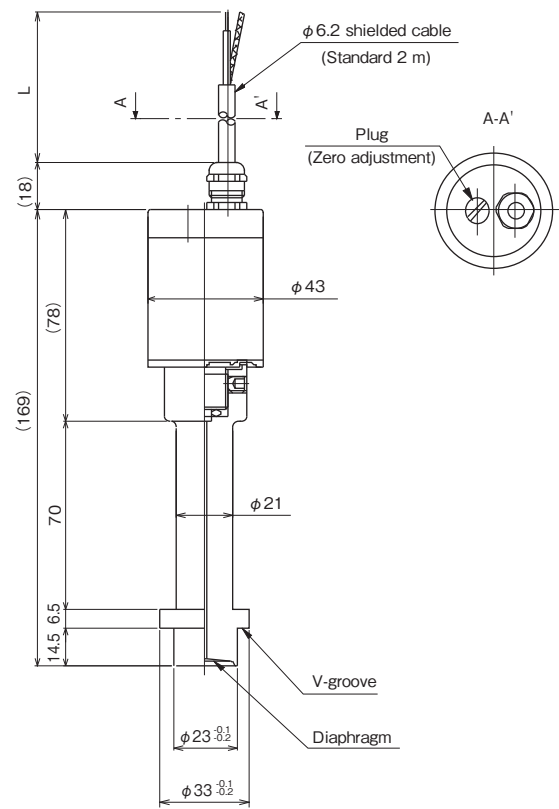

Homogenizer type

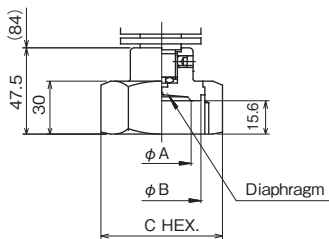

Nut type

Nut size	A	B	C
1½S	32	42.7	56x64.7 HEX.
2S	47	56.2	71x82 HEX.

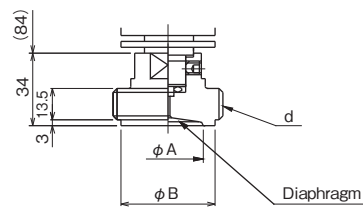

Male type

Thread size d	A	B
1½S	32	42.7
2S	47	56.2

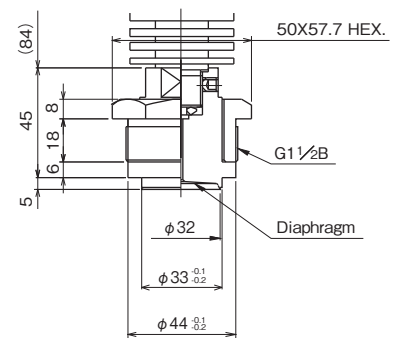

Union thread type

⚠ Caution

The 1S ferrule will be attached as shown.
Please use the 1½S gasket.

