

GP Precision Pressure Gauge

Overview

This precision pressure gauge is designed in accordance with Nagano's traceability chain for the use with standard gauge for inspection and calibration, and also for pressure indicator of pressure generator.



Features

- Easy-to-read large scale of pressure indication available.
- Precise pressure indication minimizing error yielded by friction by magnifying mechanism.
- Zero adjustment can be done by simple operation for the stable measurement.

*Pressure gauge should be selected considering media compatible with wetted parts.

NKS Type Precision Pressure Gauge

The test gauge provides high reliable accuracy throughout the use of bourdon tube and bellows for pressuer sensing element, and compact bearing in the mechanism.

Accuracy: $\pm 0.15\%$ F.S. or $\pm 0.25\%$ F.S. (500MPa, 700MPa: $\pm 0.5\%$ F.S.)

*Consult factory for $\pm 0.1\%$ F.S. for ranges 3.5MPa and below.



Precision Pressure Test Equipment (former PN Type)

This portable type test equipment in combination with precision pressure gauge (W&T or NKS type), control valve and cock etc. in one compact design is suitable for easy calibration and inspection performance for pressure instruments.



W&T Type Precision Pressure Gauge

This is a high precision pressure gauge minimizing error and hysteresis effect, utilizing Ni-Span-C for pressure sensing element, caused by transient temperature condition.

Accuracy: $\pm 0.1\%$ F.S.



NKS Type Precision Pressure Gauge

Specification

Media:

Gas or liquid
 * -Pa and below is calibrated by gas.
 Use for liquid measurement is prohibited.

Mounting:

Surface mounting (Type B), Panel (Type D)
 * D type panel mounting is also available with stand with handle.
 Contact NKS for the details. (Applicable model: GP43-24□)

Size:

200 DIA.

Connection:

G1/2B

Wetted parts:

Refer to below table.

Pressure range:

0 to 0.1 → 0 to 25MPa
 -0.1 to 0 → -0.1 to 2.5MPa

Operating temperature range:

10 to 30°C

Accuracy:

±0.25%F.S.

Case material • finish:

Aluminium alloy casting (AC7A) • Black

Treatment: (Option)

Use no oil & water ... Oil/Water used in manufacturing the gauges had been flushed out & no oil/water residue remained inside its wetted parts.

Custom dial: (Option)

Capacity scale, dual-scale, custom letters and color dial.

Weight:

Approx. 3.1kg

Minor Graduation • Wetted Parts

| Pressure Range MPa | Minor Graduation MPa | Wetted Parts Sensing element connection | |
|--------------------|----------------------|---|------------------------------|
| | | General Use GP2□-□41 | Corrosion Resistant GP2□-□43 |
| 0 to 0.1 | 0.0005 | C5212R CAC203 | — |
| 0 to 0.2 | 0.001 | | |
| 0 to 0.3 | 0.001 | | |
| 0 to 0.4 | 0.002 | | |
| 0 to 0.6 | 0.002 | | |
| 0 to 1 | 0.005 | SUS316 CAC203 | SUS316 SUS316 |
| 0 to 1.5 | 0.005 | | |
| 0 to 2 | 0.01 | | |
| 0 to 2.5 | 0.01 | | |
| 0 to 3.5 | 0.01 | | |
| 0 to 5 | 0.02 | | |
| 0 to 7 | 0.05 | | |
| 0 to 10 | 0.05 | | |
| 0 to 15 | 0.05 | | |
| 0 to 20 | 0.1 | | |
| 0 to 25 | 0.1 | | |

| Pressure Range MPa | Minor Graduation MPa | Wetted Parts Sensing element connection | |
|--------------------|----------------------|---|------------------------------|
| | | General Use GP2□-□41 | Corrosion Resistant GP2□-□43 |
| -0.1 to 0 | 0.0005 | C5212R CAC203 | — |
| -0.1 to 0.1 | 0.001 | | |
| -0.1 to 0.2 | 0.001 | | |
| -0.1 to 0.3 | 0.002 | | |
| -0.1 to 0.4 | 0.002 | | |
| -0.1 to 0.6 | 0.002 | SUS316 CAC203 | SUS316 SUS316 |
| -0.1 to 1 | 0.005 | | |
| -0.1 to 1.5 | 0.005 | | |
| -0.1 to 2 | 0.01 | | |
| -0.1 to 2.5 | 0.01 | | |

Dimensions

Unit: mm

200 DIA. Type B

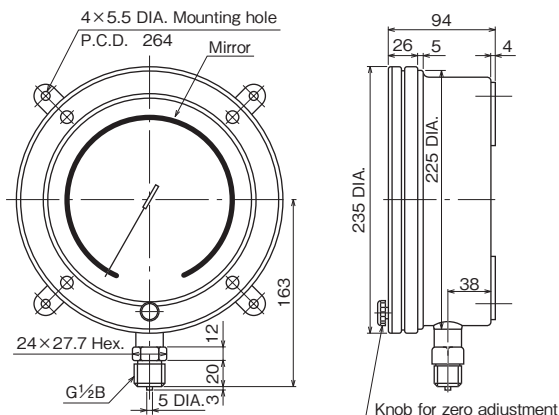

GP20-241
GP20-243

200 DIA. Type D

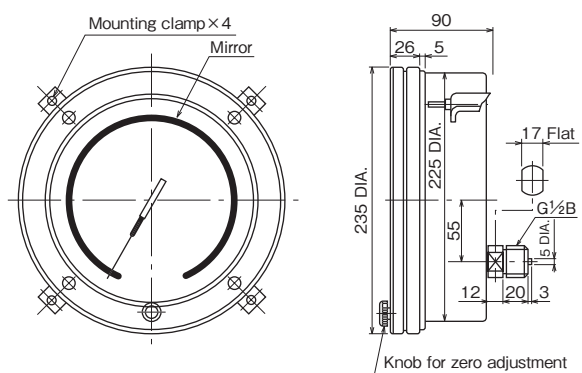

GP25-141
GP25-143

Model number configuration

Please specify the model, each requiring specification and pressure range to order.

Model

GP 2 — 4 — 000 — × × × × ×

NKS Type Precision Pressure Gauge ① ② ③ ④ ⑤ ⑥ ⑦ ⑧ ⑨ ⑩ ⑪ ⑫ ⑬ ⑭ ⑮

| Model number | | Product specifications | | Additional specifications. (Optional) | |
|-----------------------------------|-----|--|------------------|---|--|
| Model | 2 0 | 200 DIA. | Surface mounting | | |
| | 2 5 | 200 DIA. | Panel mounting | | |
| ① Mounting | 1 | Type D (Mounting clamp) | For GP25 only | | |
| | 2 | Type B (Surface mounting) | For GP25 only | | |
| ② Connection | 4 | G1/2B | | | |
| ③ Wetted Parts | 1 | General Use | | | |
| | 3 | Corrosion Resistant (SUS316) | | | |
| ④ Pressure range (MPa) | 1 | ③Wetted parts material 1: General Use | | ③Wetted parts material 3: Corrosion Resistant | |
| | 2 | -0.1 to 0.1, 0.2, 0.3, 0.4, 0.6, 1, 1.5, 2, 2.5 | | -0.1 to 0.4, 0.6, 1, 1.5, 2, 2.5 | |
| | 3 | -0.1 to 0, 0 to 0.1, 0.2, 0.3, 0.4, 0.6, 1, 1.5, 2, 2.5, 3.5 | | 0 to 0.6, 1, 1.5, 2, 2.5, 3.5 | |
| | 3 | 0 to 5, 7, 10, 15, 20, 25 (For general use and corrosion resistance) | | | |
| ⑤ Accuracy | 0 | Standard ±0.25%F.S. | | | |
| ⑥ Pointer | 0 | Standard | | | |
| ⑦ Window | 0 | Standard (Organic glass) | | | |
| ⑧ Treatment | 0 | Not required | | | |
| | 1 | Use no oil | | | |
| | 2 | Use no water | | | |
| | 3 | Use no oil • water | | | |
| ⑨ Other additional specifications | 0 | Not required | | | |
| | 1 | Required (Documents available upon request.) Custom dial [*1] | | | |
| ⑮ Documents | 0 | Not required | | | |
| | 1 | Required (Documents available upon request.) Datasheet (Drawing / Specifications), Instruction manual, Inspection procedure, Mill test report, Calibration test report (One-part one sheet), Inspection / Traceability certificate, Attending inspection | | | |

Please specify pressure range and unit of measure along with corresponding ordering code.

[*1] Custom dial: Capacity scale, dual-scale, custom letters and color dial

*Specify code "X" to refer N/A

【Attention: Replacing duplicated model numbers】

Two different model numbers with same SUS316 wetted parts specification were replaced by new model numbers. (Specifications and dimensions are not subject to change)

| SUS316 wetted parts pressure gauge | | |
|------------------------------------|------------------|------------------|
| Model | Old model number | New model number |
| 200 DIA. Surface mounting | GP20-F01 | GP20-243 |
| 200 DIA. Panel mounting | GP25-F01 | GP25-143 |

NKS Type Precision Pressure Gauge (300 DIA.)

Specification

Media:

Gas or liquid

※Pressure ranges 3.5MPa and below are calibrated by gas. Use for liquid measurement should be avoided. For the ranges 5MPa and above, hydrogen embrittlement could cause wetted parts to lose material strength of utilized high-tensile steel where the process media is water or liquid containing media. Avoid using in the condition.

Mounting:

Surface mounting (Type B), Panel (Type D)

*D type panel mounting is also available with stand with handle.

Contact NKS for the details. (Applicable model: GP43-34□)

Size:

300 DIA.

Connection:

G1/2B

*G1/2 (female) comes for the ranges 100MPa and above with GP35

Wetted parts:

Refer to below table.

Pressure range:

0 to 0.1→0 to 700MPa

-0.1 to 0→-0.1 to 2.5MPa

Operating temperature range:

10 to 30°C

Accuracy:

±0.15%F.S.

* ±0.5%F.S. for ranges 500MPa and above.

* ±0.1%F.S. available for ranges 3.5MPa and below.

Case material • finish:

Aluminium alloy casting (AC7A) • Black

Treatment: (Option)

Use no oil & water ... Oil/Water used in manufacturing the gauges had been flushed out & no oil/water residue remained inside its wetted parts.

Custom dial: (Option)

Capacity scale, dual-scale, custom letters and color dial.

Weight:

Approx. 4.5kg

Minor Graduation • Wetted Parts

| Pressure Range MPa | Minor Graduation MPa | Wetted Parts Sensing element connection | | Pressure Range MPa | Minor Graduation MPa | Wetted Parts Sensing element connection | |
|--------------------|----------------------|---|---------------------|--------------------|----------------------|--|---------------------|
| | | General Use | Corrosion Resistant | | | General Use | Corrosion Resistant |
| | | GP35-141 | GP35-143 | | | GP35-141 | GP35-143 |
| 0 to 0.1 | 0.0002 | C5212R CAC203 | — | 0 to 70 | 0.1 | High tensile steel SUS316 | — |
| 0 to 0.2 | 0.0005 | | | 0 to 100 | 0.2 | | |
| 0 to 0.3 | 0.0005 | | | 0 to 200 | 0.5 | | |
| 0 to 0.4 | 0.001 | | | 0 to 350 | 0.5 | | |
| 0 to 0.6 | 0.001 | SUS316 CAC203 | SUS316 SUS316 | 0 to 500 | 1.0 | High tensile steel High tensile steel | — |
| 0 to 1 | 0.002 | | | 0 to 700 | 1.0 | | |
| 0 to 1.5 | 0.005 | | | -0.1 to 0 | 0.0002 | | |
| 0 to 2 | 0.005 | | | -0.1 to 0.1 | 0.0005 | | |
| 0 to 2.5 | 0.005 | High tensile steel SUS316 | — | -0.1 to 0.2 | 0.0005 | C5212R CAC203 | — |
| 0 to 3.5 | 0.005 | | | -0.1 to 0.3 | 0.001 | | |
| 0 to 5 | 0.01 | | | -0.1 to 0.4 | 0.001 | | |
| 0 to 10 | 0.02 | | | -0.1 to 0.6 | 0.001 | | |
| 0 to 15 | 0.05 | SUS316 CAC203 | — | -0.1 to 1 | 0.002 | SUS316 CAC203 | SUS316 SUS316 |
| 0 to 25 | 0.05 | | | -0.1 to 1.5 | 0.005 | | |
| 0 to 35 | 0.05 | | | -0.1 to 2 | 0.005 | | |
| 0 to 50 | 0.1 | | | -0.1 to 2.5 | 0.005 | | |

Dimensions

Unit: mm

300 DIA. Type D

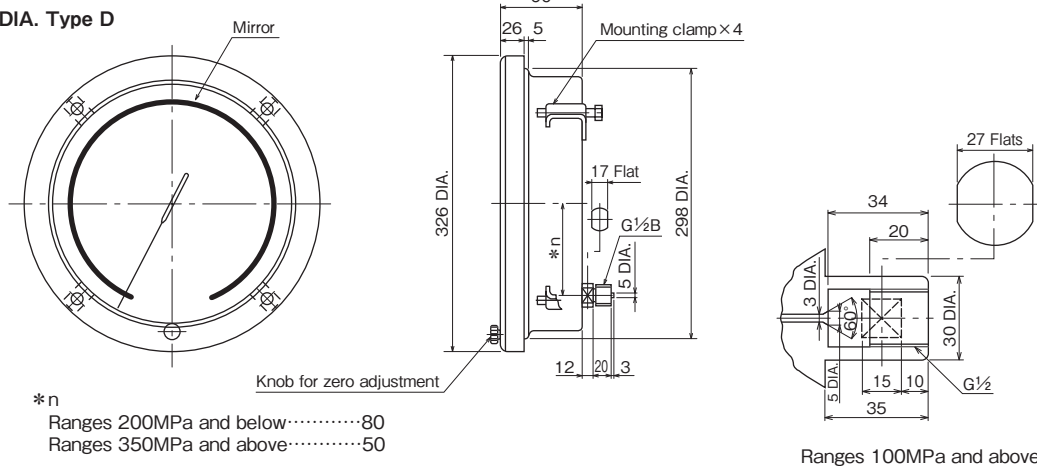

GP35-141
GP35-143

Model number configuration

Please specify the model, each requiring specification and pressure range to order.

Model

GP 3 5 — **1 4** — **0 0 0** × × × × ×

NKS Type Precision Pressure Gauge ① ② ③ ④ ⑤ ⑥ ⑦ ⑧ ⑨ ⑩ ⑪ ⑫ ⑬ ⑭ ⑮

| | | | | | | | | | | | |
|-----------------------------------|---|---|---|--|--|---|--|--|--|--|--|
| Model number | | | Product specifications | | | Additional specifications. (Optional) | | | | | |
| Model | 3 | 5 | 300 DIA. Panel mounting | | | | | | | | |
| ① Mounting | 1 | | Type D (Mounting clamp) | | | | | | | | |
| ② Connection | 4 | | G1/2B (G1/2 (female) comes for the range 100MPa and above) | | | | | | | | |
| ③ Wetted parts | 1 | | General Use | | | | | | | | |
| | 3 | | Corrosion Resistant (SUS316) | | | | | | | | |
| ④ Pressure range (MPa) | 1 | | ③Wetted parts material 1: General Use | | | ③Wetted parts material 3: Corrosion Resistant | | | | | |
| | 2 | | -0.1 to 0.1, 0.2, 0.3, 0.4, 0.6, 1, 1.5, 2, 2.5 | | | -0.1 to 0.6, 1, 1.5, 2, 2.5 | | | | | |
| | 3 | | -0.1 to 0, 0 to 0.1, 0.2, 0.3, 0.4, 0.6, 1, 1.5, 2, 2.5, 3.5 | | | 0 to 0.6, 1, 1.5, 2, 2.5, 3.5 | | | | | |
| | 4 | | 0 to 5, 10, 15, 25 | | | _____ | | | | | |
| | 5 | | 0 to 35, 50, 70, 100 | | | _____ | | | | | |
| | 6 | | 0 to 200, 350 | | | _____ | | | | | |
| ⑤ Accuracy * | 0 | | Standard ±0.15%F.S. or ±0.5%F.S. (±0.5%F.S. for ranges 500MPa and above.) | | | | | | | | |
| | 0 | | Standard | | | | | | | | |
| ⑥ Pointer | 0 | | Standard | | | | | | | | |
| ⑦ Window | 0 | | Standard (Organic glass) | | | | | | | | |
| ⑧ Treatment | 0 | | Not required | | | | | | | | |
| | 1 | | Use no oil (For ranges 3.5MPa and below) | | | | | | | | |
| | 2 | | Use no water | | | | | | | | |
| | 3 | | Use no oil+water (For ranges 3.5MPa and below) | | | | | | | | |
| ⑨ Other additional specifications | 0 | | Not required | | | | | | | | |
| | 1 | | Required (Documents available upon request) Custom dial [*1] | | | | | | | | |
| ⑮ Documents | 0 | | Not required | | | | | | | | |
| | 1 | | Required (Documents available upon request) Datasheet (Drawing / Specifications), Instruction manual, Inspection procedure, Mill test report, Calibration test report (One-part one sheet), Inspection / Traceability certificate, Attending inspection | | | | | | | | |

Please specify pressure range and unit of measure along with corresponding ordering code.

*Consult factory for ±0.1%F.S. for ranges 3.5MPa and below.

[*1] Custom dial: Capacity scale, dual-scale, custom letters and color dial

*Specify code "X" to refer N/A

【Attention: Replacing old model number】

Two different model numbers with same SUS316 wetted parts specification were replaced by new model numbers. (Specifications and dimensions are not subject to change)

| SUS316 wetted parts pressure gauge | | |
|------------------------------------|------------------|------------------|
| Model | Old model number | New model number |
| 300 DIA. Panel mounting | GP35-F01 | GP35-143 |

Stand with handle

NKS Type Precision Pressure Gauge

Specification

Media:

Gas or liquid
 *Pressure range 3.5MPa and below is calibrated by gas. Use for liquid measurement should be avoided.

Mounting:

Stand with handle

Size:

200 DIA.

Connection:

G1/2B

Wetted parts:

Refer to below table.

Pressure range:

0 to 0.1 → 0 to 25MPa
 -0.1 to 0 → -0.1 to 2.5MPa

Operating temperature range:

10 to 30°C

Accuracy:

±0.25%F.S.

Case material • finish:

Aluminium alloy casting (AC7A) • Black

Treatment: (Option)

Use no oil & water ... Oil/Water used in manufacturing the gauges had been flushed out & no oil/water residue remained inside its wetted parts.

Custom dial: (Option)

Capacity scale, dual-scale, custom letters and color dial.

Minor Graduation • Wetted Parts

| Pressure Range MPa | Minor Graduation MPa | Wetted Parts Sensing element connection | |
|--------------------|----------------------|---|---------------------|
| | | General Use | Corrosion Resistant |
| 0 to 0.1 | 0.0005 | GP43-241 | GP43-243 |
| 0 to 0.2 | 0.001 | C5212R CAC203 | — |
| 0 to 0.3 | 0.001 | | |
| 0 to 0.4 | 0.002 | SUS316 CAC203 | SUS316 SUS316 |
| 0 to 0.6 | 0.002 | | |
| 0 to 1 | 0.005 | | |
| 0 to 1.5 | 0.005 | | |
| 0 to 2 | 0.01 | | |
| 0 to 2.5 | 0.01 | | |
| 0 to 3.5 | 0.01 | | |
| 0 to 5 | 0.02 | | |
| 0 to 7 | 0.05 | | |
| 0 to 10 | 0.05 | | |
| 0 to 15 | 0.05 | | |
| 0 to 20 | 0.1 | | |
| 0 to 25 | 0.1 | | |

| Pressure Range MPa | Minor Graduation MPa | Wetted Parts Sensing element connection | |
|--------------------|----------------------|---|---------------------|
| | | General Use | Corrosion Resistant |
| -0.1 to 0 | 0.0005 | GP43-241 | GP43-243 |
| -0.1 to 0.1 | 0.001 | | |
| -0.1 to 0.2 | 0.001 | | |
| -0.1 to 0.3 | 0.002 | SUS316 CAC203 | SUS316 SUS316 |
| -0.1 to 0.4 | 0.002 | | |
| -0.1 to 0.6 | 0.002 | | |
| -0.1 to 1 | 0.005 | | |
| -0.1 to 1.5 | 0.005 | | |
| -0.1 to 2 | 0.01 | | |
| -0.1 to 2.5 | 0.01 | | |

Dimensions

Unit: mm

200 DIA. with stand

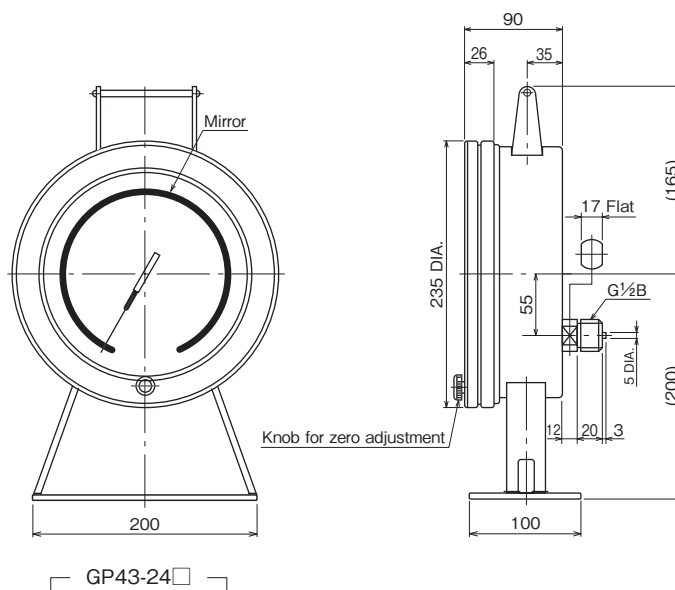

Model number configuration

Please specify the model, each requiring specification and pressure range to order.

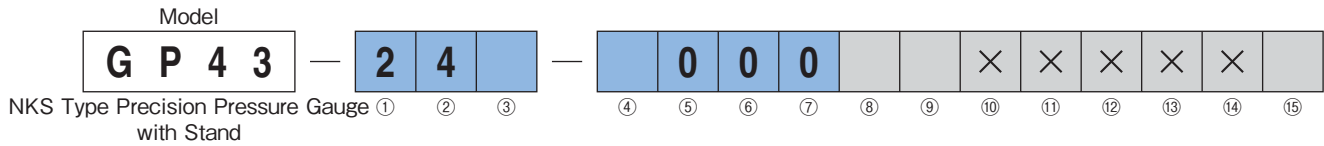

| Model number | Product specifications | Additional specifications. (Optional) |
|-----------------------------------|------------------------|---|
| ① Mounting | 2 | 200 DIA. with stand |
| ② Connection | 4 | G1/2B |
| ③ Wetted parts | 1 | General Use |
| | 3 | Corrosion Resistant (SUS316) |
| ④ Pressure range (MPa) | 1 | ③Wetted parts material 1: General Use -0.1 to 0.1, 0.2, 0.3, 0.4, 0.6, 1, 1.5, 2, 2.5 |
| | 2 | ③Wetted parts material 3: Corrosion Resistant -0.1 to 0.4, 0.6, 1, 1.5, 2, 2.5 |
| | 3 | 0 to 0.1, 0.2, 0.3, 0.4, 0.6, 1, 1.5, 2, 2.5, 3.5 0 to 0.6, 1, 1.5, 2, 2.5, 3.5 |
| ⑤ Accuracy | 0 | Standard ±0.25%F.S. |
| ⑥ Pointer | 0 | Standard |
| ⑦ Window | 0 | Standard (Organic glass) |
| ⑧ Treatment | 0 | Not required |
| | 1 | Use no oil |
| | 2 | Use no water |
| | 3 | Use no oil•water |
| ⑨ Other additional specifications | 0 | Not required |
| | 1 | Required (Documents available upon request) Custom dial [*1] |
| ⑮ Documents | 0 | Not required |
| | 1 | Required (Documents available upon request) Datasheet (Drawing / Specifications), Instruction manual, Inspection procedure, Mill test report, Calibration test report (One-part one sheet), Inspection / Traceability certificate, Attending inspection |

Please specify pressure range and unit of measure along with corresponding ordering code.

[*1] Custom dial: Capacity scale, dual-scale, custom letters and color dial

*Specify code "X" to refer N/A

【Attention: Replacing old model number】

Two different model numbers with same SUS316 wetted parts specification were replaced by new model numbers. (Specifications and dimensions are not subject to change)

| SUS316 wetted parts pressure gauge | | |
|------------------------------------|------------------|------------------|
| Model | Old model number | New model number |
| 200 DIA. with stand | GP43-F03 | GP43-243 |

Model number configuration

Please specify the model, each requiring specification and pressure range to order.

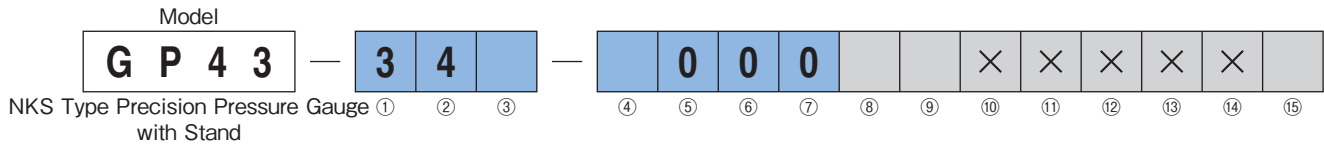

| Model number | Product specifications | Additional specifications. (Optional) |
|-----------------------------------|------------------------|--|
| ① Mounting | 3 | 300 DIA. with stand |
| ② Connection | 4 | G1/2B (G1/2 (female) comes for the range 100MPa and above) |
| ③ Wetted parts | 1 | General Use |
| | 3 | Corrosion Resistant (SUS316) |
| ④ Pressure range (MPa) | 1 | ③Wetted parts material 1: General Use -0.1 to 0.1, 0.2, 0.3, 0.4, 0.6, 1, 1.5, 2, 2.5 |
| | 2 | ③Wetted parts material 3: Corrosion Resistant -0.1 to 0.6, 1, 1.5, 2, 2.5 |
| | 3 | 0 to 0.6, 1, 1.5, 2, 2.5, 3.5 |
| | 4 | 0 to 5, 10, 15, 25 |
| | 5 | 0 to 35, 50, 70, 100 |
| | 6 | 0 to 200, 350 |
| ⑤ Accuracy | 0 | Standard ±0.15%F.S. or ±0.5%F.S. (±0.5%F.S. for ranges 500MPa and above.) |
| ⑥ Pointer | 0 | Standard |
| ⑦ Window | 0 | Standard (Organic glass) |
| ⑧ Treatment | 0 | Not required |
| | 1 | Use no oil (For ranges 3.5MPa and below) |
| | 2 | Use no water |
| | 3 | Use no oil•water (For ranges 3.5MPa and below) |
| ⑨ Other additional specifications | 0 | Not required |
| | 1 | Required (Documents available upon request) Custom dial[*1] |
| ⑮ Documents | 0 | Not required |
| | 1 | Required (Documents available upon request) Datasheet (Drawing / Specifications), Instruction manual, Inspection procedure, Mill test report, Clibration test report (One-part one sheet), Inspection / Traceability certificate, Attending inspection |

Please specify pressure range and unit of measure along with corresponding ordering code.

*[*1] Custom dial: Capacity scale, dual-scale, custom letters and color dial

*Specify code "X" to refer N/A

【Attention: Replacing old model number】

Two different model numbers with same SUS316 wetted parts specification were replaced by new model numbers. (Specifications and dimensions are not subject to change)

| SUS316 wetted parts pressure gauge | | |
|------------------------------------|------------------|------------------|
| Model | Old model number | New model number |
| 300 DIA. with stand | GP43-F01 | GP43-343 |

Precision Pressure Test Equipment (PN Type)

Specification

Media:

Gas or liquid

*Pressure ranges 3.5MPa and below are calibrated by gas. Use for liquid measurement should be avoided. For the ranges GP41 with 5MPa and above, hydrogen embrittlement could cause wetted parts to lose material strength of utilized high-tensile steel where the process media is water or liquid containing media. Avoid using in the condition.

Application:

Pressure, differential pressure measurement (GP42 only)

Indicator:

GP41 NKS Type 300 DIA. (GP35-141)

GP42 W&T Type (GP15-201)

Connection:

GP41 Rc1/4

GP42 Rc1/8

Wetted parts:

Refer to below table.

Pressure range:

GP41 0 to 0.1→0 to 35MPa

GP42 0 to 0.1→0 to 0.4MPa

Operating temperature range:

10 to 30°C

Accuracy:

GP41 ±0.15%F.S.

GP42 ±0.1%F.S.

Finish:

Black leather tension

Treatment: (Option)

Use no oil & water ... Oil/Water used in manufacturing the gauges had been flushed out & no oil/water residue remained inside its wetted parts.

Custom dial: (Option)

Capacity scale, dual-scale, custom letters and color dial.

Minor Graduation • Wetted Parts

GP41

| Pressure Range MPa | Minor Graduation MPa | Wetted Parts Sensing element connection |
|--------------------|----------------------|--|
| 0 to 0.1 | 0.0002 | C5212R CAC203 |
| 0 to 0.2 | 0.0005 | |
| 0 to 0.4 | 0.001 | |
| 0 to 0.6 | 0.001 | SUS316 CAC203 |
| 0 to 1 | 0.002 | |
| 0 to 1.5 | 0.005 | |
| 0 to 2 | 0.005 | |
| 0 to 3.5 | 0.005 | |
| 0 to 5 | 0.01 | High tensile steel SUS316 |
| 0 to 10 | 0.02 | |
| 0 to 15 | 0.05 | |
| 0 to 25 | 0.05 | |
| 0 to 35 | 0.05 | |

GP42

| Pressure Range MPa | Minor Graduation MPa | Wetted Parts |
|--------------------|----------------------|---|
| 0 to 0.1 | 0.0001 | Sensing element side: Ni-Span-C, Solder, Brass, Stainless steel, Silver solder |
| 0 to 0.2 | 0.0002 | Case side: Ni-Span-C, Brass, Stainless steel, Phosphor bronze, Beryllium copper, Magnesium, Aluminum, Nylon, ELGILOY, Solder, Silver solder, HYPALON |
| 0 to 0.4 | 0.0005 | |

Dimensions

Unit: mm

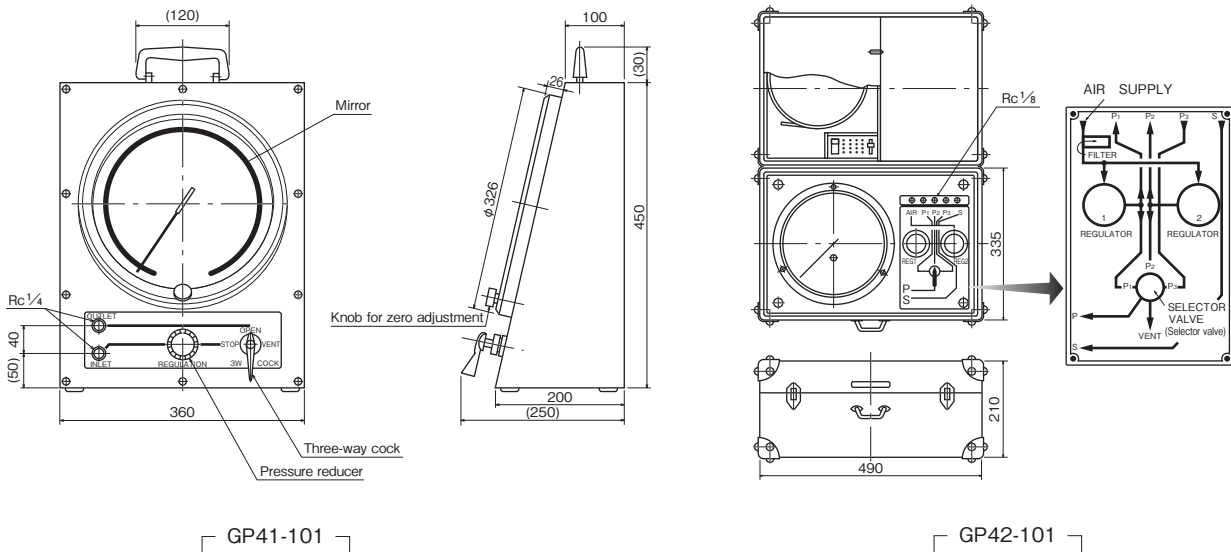

External appearance is differ from showing picture where GP41-501 is required with 0.6MPa and above.

Model number configuration

Please specify the model, each requiring specification and pressure range to order.

Model

GP4 — 01 — 000 × × × × ×

Precision Pressure Test Equipment ① ② ③ ④ ⑤ ⑥ ⑦ ⑧ ⑨ ⑩ ⑪ ⑫ ⑬ ⑭ ⑮

| Model number | | | Product specifications | | Additional specifications. (Optional) | | |
|-----------------------------------|-----------|---|------------------------|--|---------------------------------------|--------------------|---|
| Model | Indicator | | Range (MPa) | | | | |
| | 1 | — | 1 | GP35-141 | | | 0 to 0.1, 0.2, 0.4 |
| | 1 | — | 5 | GP35-141 | | | 0 to 0.6, 1, 1.5, 2, 3.5, 5, 10, 15, 25, 35 |
| 2 | — | 1 | GP15-201 | | | 0 to 0.1, 0.2, 0.4 | |
| ④ Pressure range (MPa) | | | 1 | 0 to 0.1, 0.2, 0.4 | GP41-101, GP42-101 | | |
| | | | 2 | 0 to 0.6, 1, 2, 3.5 | GP41-501 | | |
| | | | 3 | 0 to 5, 10 | GP41-501 | | |
| | | | 4 | 0 to 25 | GP41-501 | | |
| | | | 5 | 0 to 35 | GP41-501 | | |
| ⑤ Accuracy | | | 0 | Standard GP41: ±0.15%F.S. GP42: ±0.1%F.S. | | | |
| ⑥ Pointer | | | 0 | Standard | | | |
| ⑦ Window | | | 0 | Standard (Organic glass) | | | |
| ⑧ Treatment | | | 0 | Not required | | | |
| | | | 1 | Use no oil (For ranges 3.5MPa and below) | | | |
| | | | 2 | Use no water | | | |
| ⑨ Other additional specifications | | | 3 | Use no oil•water (For ranges 3.5MPa and below) | | | |
| | | | 0 | Not required | | | |
| | | | 1 | Required (Documents available upon request) Custom dial[*1] | | | |
| ⑮ Documents | | | 0 | Not required | | | |
| | | | 1 | Required (Documents available upon request) Datasheet (Drawing / Specifications), Instruction manual, Inspection procedure, Calibration test report (One-part one sheet), Inspection / Traceability certificate, Attending inspection | | | |

Please specify pressure range and unit of measure along with corresponding ordering code.

[Scope of production]
[*1] Custom dial: Capacity scale, dual-scale, custom letters and color dial

• GP42 comes with the followings
6 DIA. x 6m nylon pipe
R1/8 x 6 DIA. x 6m nylon pipe fitting

*Specify code "X" to refer N/A

W&T Type Precision Pressure Gauge

Specification

Media:

Gas

Mounting:

GP15: 62-075 Series 1500 Pressure measurement, differential pressure measurement

GP16: 62-050 Series 1500 Pressure measurement, vacuum measurement

GP17: 61-075 Series 1500 Absolute pressure measurement, atmospheric pressure measurement

Connection:

1/8NPT female,

1/4NPT female (Available model GP16-201
0 to 2, 3.5MPa only)

Wetted parts:

Refer to below table.

Pressure range:

GP15: 0 to 0.1→0 to 1MPa

GP16: -0.1 to 0, 0 to 2, 3.5MPa

GP17: 0 to 0.1, 0.3MPa abs., 0 to 1060 mbar abs.

Proof pressure for case:

0.25MPa

Operating temperature range:

10 to 30°C

Accuracy:

±0.1%F.S.

Case material • finish:

Aluminium alloy casting (AC7A) • Black

Treatment: (Option)

Use no oil & wate

Custom dial: (Option)

Capacity scale, dual-scale, custom letters and color dial

Weight:

Approx. 3.8kg

Minor Graduation • Characteristics

| Model Number | Type | Pressure Range MPa | Minor Graduation MPa | Connection | Hysteresis %F.S. | Sensitivity %F.S. | Max. *1 Temperature Error | Capacity ml | Material in Contact with Process Media |
|----------------|--------------------|--------------------|----------------------|---------------|------------------|-------------------|---------------------------|------------------|---|
| GP15-201 | 62-075 Series 1500 | 0 to 0.1 | 0.0001 | 1/8NPT female | 0.1 | 0.01 | 0.1 | 7 | Sensing element side: Ni-Span-C, Solder, Brass, Stainless steel, Silver solder Case side: Ni-Span-C, Brass, Stainless steel, Phosphor bronze, Beryllium copper, Magnesium, Aluminum, Nylon, ELGILOY, Solder, Silver solder, HYPALON |
| | | 0 to 0.2 | 0.0002 | | | | | | |
| | | 0 to 0.4 | 0.0005 | | | | | | |
| | | 0 to 1 | 0.001 | | 0.2 | | | | |
| GP16-201 | 62-050 Series 1500 | -0.1 to 0 | 0.0001 | 1/8NPT female | 0.1 | 0.0125 | 0.1 | 7 | -0.1MPa range: Ni-Span-C, Brass, Stainless steel, Solder, Silver solder 2MPa and above: Ni-Span-C, Stainless steel, Nylon, Silver solder, Free cutting brass |
| | | 0 to 2 | 0.002 | 1/4NPT female | | | | 10 | |
| | | 0 to 3.5 | 0.005 | | | | | | |
| *2 GP17-201 | 61-050 Series 1500 | 0 to 0.1(abs.) | 0.0001 | 1/8NPT female | 0.15 | 0.01 | 0.019 | 3070 (Case side) | Ni-Span-C, Brass, Phosphor bronze, Solder, Beryllium copper, Magnesium, Aluminum, Nylon, Stainless steel, ELGILOY, Silver solder, HYPALON |
| | | 0 to 0.3(abs.) | 0.0005 | | | | | | |
| | | 1060(mbar abs.) | 1(mbar abs.) | | | | | | |

*1 The maximum temperatures error is a percentage of the full span.
%F.S./10°C at 20°C

*2 Leakage amounts of GP17-201 case 1.04×10^{-4} Pa·m³/s (1.03×10⁻³ atm cc/s) or less.

Dimensions

Unit: mm

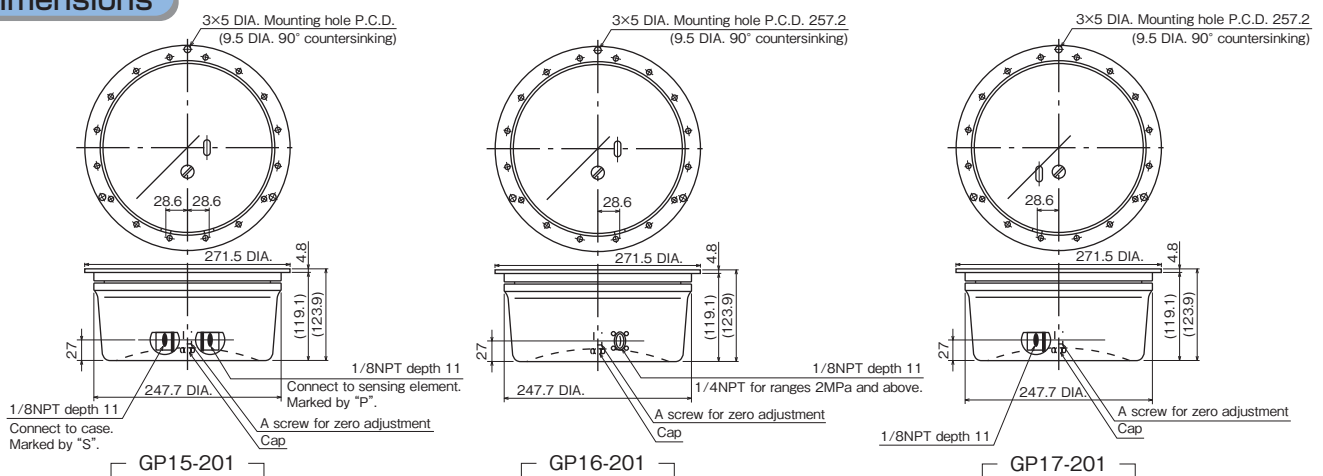

Model number configuration

Please specify the model, each requiring specification and pressure range to order.

Model: **GP1** — **201** — **1000** × × × × ×

W&T Type Precision Pressure Gauge ① ② ③ ④ ⑤ ⑥ ⑦ ⑧ ⑨ ⑩ ⑪ ⑫ ⑬ ⑭ ⑮

| Model number | | Product specifications | | Additional specifications. (Optional) | |
|--------------|---------------------------------|---|---|--|--|
| Model | Type | Application | Pressure sensing element | Connection | |
| 5 | 62-075 Series 1500 | Pressure, Differential pressure | Ni-Span-c | 1/8NPT female | |
| 6 | 62-050 Series 1500 | Pressure, Vacuum pressure | Ni-Span-c | 1/8NPT female (Available -0.1 to 0MPa only.) 1/8NPT female (Available 0 to 2, 3.5MPa only.) | |
| 7 | 61-050 Series 1500 | Absolute pressure, Atmospheric pressure | Ni-Span-c | 1/8NPT female | |
| ④ | Pressure range (MPa) | 1 | GP15: 0 to 0.1, 0.2, 0.4, 1 GP16: -0.1 to 0, 0 to 2, 3.5 GP17: 0 to 0.1, 0.3 (abs.), 1060 (mbar abs.) | | |
| ⑤ | Accuracy | 0 | Standard (±0.1%F.S.) | | |
| ⑥ | Pointer | 0 | Standard | | |
| ⑦ | Window | 0 | Standard (Inorganic glass) | | |
| ⑧ | Treatment | 0 | Not required | | |
| | | 1 | Use no oil | | |
| | | 2 | Use no water | | |
| | | 3 | Use no oil•water | | |
| ⑨ | Other additional specifications | 0 | Not required | | |
| | | 1 | Required (Documents available upon request) Custom dial[*1] | | |
| ⑮ | Documents | 0 | Not required | | |
| | | 1 | Required (Documents available upon request) Datasheet (Drawing / Specifications), Instruction manual, Inspection procedure, Calibration test report (One-part one sheet), Inspection / Traceability certificate, Attending inspection | | |

Please specify pressure range and unit of measure along with corresponding ordering code.

[*1] Custom dial: Capacity scale, dual-scale, custom letters and color dial

*Specify code "X" to refer N/A