

# EH15 Pressure Sensor

Fluids and gases measurement  
(Featuring stainless diaphragm)

## Overview

EH15 is a pressure sensor that supports various electrical connections and offers excellent temperature performance. It covers a wide pressure range to meet the needs of various industries and applications. It is also suitable for low-pressure hydrogen applications and marine applications (NK-certified). With its extensive lineup, it is suitable for use across diverse industries.

## Features

- Accuracy:  $\pm 0.25\%$  F.S. (at 23°C)
- Lineup for wide range of industrial applications (standard model), low-pressure hydrogen, and marine models.
- Equipped with a zero-point adjustment mechanism (enclosure side).
- Supports absolute pressure and low-to-high gauge pressure ranges.



M12 connector type

Terminal box type (large)



## Features of sensor

### Absolute/low gauge pressure

Stainless Steel Sealed Diaphragm Sensor (liquid-filled)

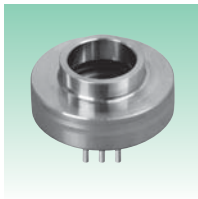

This sensor is a liquid-filled pressure sensor with SUS316L used for all wetted parts. Silicone oil is filled behind the pressure-receiving SUS316L diaphragm, and it incorporates a MEMS sensing element capable of measuring absolute pressure and low-range gauge pressure. It is suitable for gas and liquid pressure measurements requiring high corrosion resistance, and delivers high stability and high accuracy.

### Medium-to-high gauge pressure range

Semiconductor Strain Gauge Sensor (non-liquid-filled)



The semiconductor strain-gauge vapor-deposition sensor, proven in a wide range of industrial applications, has an integrated structure in which the semiconductor strain gauge, pressure-sensing element, and connection section are formed as a single unit. Because it uses no adhesives or corrosive materials, it offers excellent durability and stability and is suitable for pressure measurement of various media, including liquids and gases.

### Low gauge pressure

-100kPa 0  
Medium-to-high gauge pressure range

### Absolute

0 0~120kPa abs.

### Medium-to-high gauge pressure range

150MPa

※Includes linearity, hysteresis, and repeatability.

Pressure range	Max. allowable pressure *Note	Accuracy*	Temperature coefficient (for both zero point and span)	Wetted parts material
-20 to 20kPa	200kPa	$\pm 0.25\%$ F.S. (at 23 $\pm 2^\circ$ C)	$\pm 0.05\%$ F.S./ $^\circ$ C (at -30 to 80 $^\circ$ C)	Diaphragm: SUS316L
-50 to 50kPa				
-100 to 0kPa				
0 to 35kPa	200kPa			
0 to 50kPa				
0 to 100kPa				
0 to 120kPa abs.	200kPa abs.	$\pm 0.25\%$ F.S. (at 23 $\pm 2^\circ$ C)	$\pm 0.025\%$ F.S./ $^\circ$ C (at -30 to 80 $^\circ$ C)	Fitting : SUS316 L
-100 to 100kPa	400kPa			
-100 to 200kPa				
-100 to 300kPa	1000kPa			
0 to 200kPa	400kPa			
0 to 300kPa	1000kPa			

\* Note : For NK-certified marine products, the maximum allowable pressure is 1.5 times the pressure range.  
Allowable vacuum pressure: 130Pa abs. higher.  
Fill fluid: Silicone oil.





Pressure range	Max. allowable pressure	Accuracy	Total error band*	Wetted parts material
-0.1 to 0.5MPa	2 x pressure range	$\pm 0.25\%$ F.S. (at 23 $\pm 2^\circ$ C)	$\pm 0.5\%$ F.S. (at -20 to 70 $^\circ$ C)	Diaphragm: SUS630 (17-4PH)
-0.1 to 1MPa				
-0.1 to 2MPa				
0 to 0.5MPa				
0 to 1MPa				
0 to 2MPa				
0 to 3.5MPa	1.5 x pressure range	$\pm 0.75\%$ F.S. (at -30 to 80 $^\circ$ C)		Fitting : SUS304
0 to 5MPa				
0 to 10MPa				
0 to 20MPa	1.2 x pressure range			
0 to 35MPa				
0 to 50MPa				
0 to 70MPa	1.2 x pressure range			
0 to 100MPa				
0 to 150MPa				
Low-pressure hydrogen	1.5 x pressure range			Diaphragm/ Fitting : SUS316L
0 to 0.3MPa				
0 to 1MPa				

\*1: NK-certified marine products are excluded from CE and UKCA requirements.

# EH15

## Pressure Sensor

### Appearance

Connection type		M12 connector type	DIN connector type	Cable type	Terminal box type (Small)	Terminal box type (Large)
Appearance						
Weight		Approx. 150g	Approx. 200g	Approx. 150g	Approx. 300g	Approx. 400g
Availability	Standard	○	○	○	○	○
	Low-pressure hydrogen	○	—	—	○	—
	Marine	○	—	—	—	—

#### ●Zero Adjustment Mechanism (Side)

Zero adjustment is possible using the analog trimmer under the rubber cap.



Zero adjustment trimmer (under the rubber cap)

### Specifications

Item	Description		
	Standard	Low-pressure hydrogen	Marine
Measured fluid	Gas or liquid (must not corrode wetted parts materials)	Hydrogen and ammonia (Non-corrosive gas for SUS316L)	Gas or liquid (Non-corrosive to SUS316L)
Materials of wetted parts	<b>[Medium-to-high gauge pressure range]</b> Pressure sensor: SUS630(17-4PH), Fitting: SUS304 <b>[Absolute / Low gauge pressure]</b> (Liquid-filled: silicone oil), Pressure sensor: SUS316L Fitting: SUS316L	Pressure sensor: SUS316L, Fitting: SUS316L	Pressure sensor: SUS316L, Fitting: SUS316L (Liquid-filled: silicone oil)
Pressure range	Gauge	from 0 to 35kPa up to 0 to 150MPa	0 to 0.3MPa, 0 to 1MPa
	Compound	from -20 to 20kPa up to -0.1 to 2MPa	—
	Absolute	0 to 120kPa abs.	—
Power supply	12 to 36V DC 15 to 36V DC (for 0 to 10V DC output)	12 to 36V DC	24V DC±10%
Output signal	<b>[2-wire system]</b> 4 to 20mA DC <b>[3-wire system]</b> 0 to 5V DC, 0 to 10V DC, 1 to 5V DC	<b>[2-wire system]</b> 4 to 20mA DC <b>[3-wire system]</b> 1 to 5V DC	<b>[2-wire system]</b> 4 to 20mA DC
Accuracy *1	±0.25%F.S. at 23°C±2°C ※For total error band and temperature effects, see the pressure range table at the bottom of the first page this product section.		
Load resistance	Current output: 500Ω or less (at 24V DC)	Voltage output: 10kΩ or more	500Ω or less (at 24V DC)
Insulation resistance	100MΩ min. at 50V DC (between fitting and all terminals shorted together)		
Withstand voltage	500V AC for 1 min. (between fitting and all terminals shorted together)		—
Operating temp. / humidity range *2	-30 to 80°C, 85%RH max. ; no condensation or freezing		
Storage temp. / humidity range *2	-40 to 90°C, 95%RH max. ; no condensation or freezing		
Case structure	IP65 (with atmospheric vent)		
Case material	SUS304, chloroprene rubber, brass with nickel plating (cable, terminal box), ADC12(Terminal BOX, PBT(DIN)	SUS304, chloroprene rubber, brass with nickel plating (M12 connector), ADC12(Terminal BOX)	SUS304, chloroprene rubber, brass with nickel plating (M12 connector)
Connection thread *3	R1/4, R3/8 (R thread: 50MPa max.), G3/8G	G1/4B	R1/4, R3/8, G3/8B
Electrical connection	M12 connector, DIN connector, Cable, Terminal box (large, small)	M12 connector, Terminal box (small)	M12 connector
Response time	2 ms or less.		

\*1 : At 23±2°C, including linearity, hysteresis, and repeatability. \*2: For the M12 connector type, the connector section: -25 to 70°C, 20 to 85% RH

\*3: For other fittings, please contact us.

### Dimensions 1

#### M12 connector type

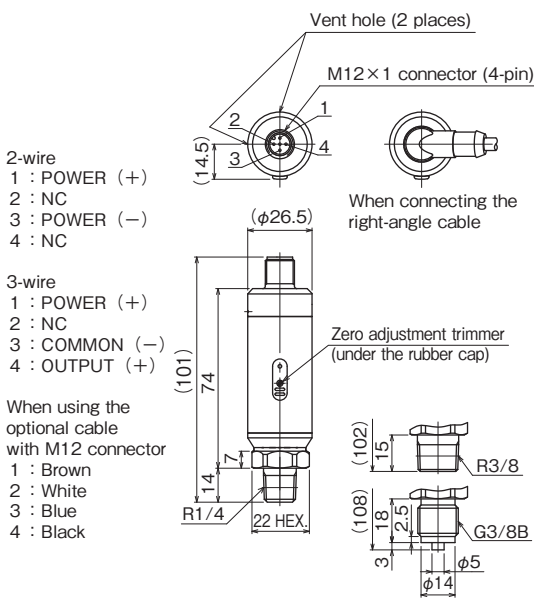

#### DIN connector type

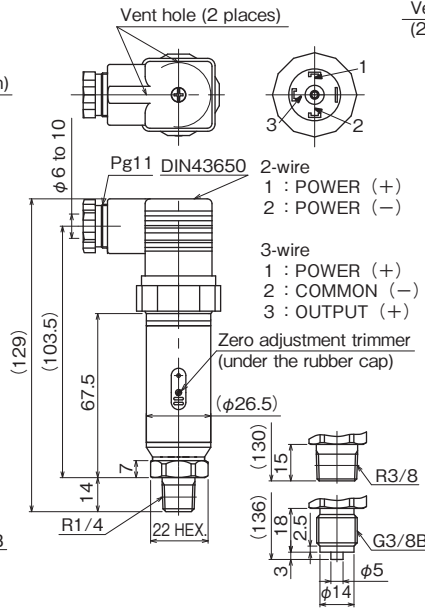

#### Cable type

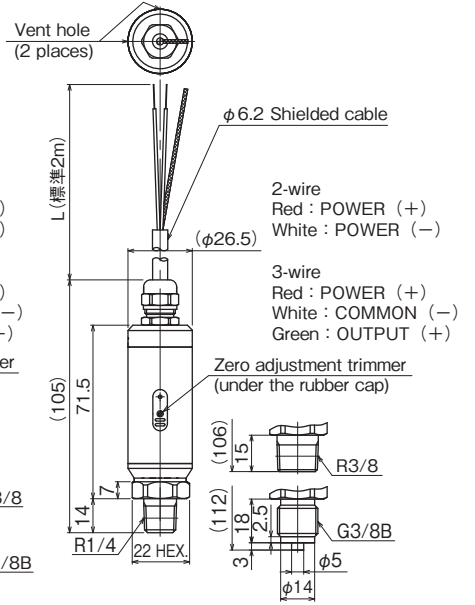

#### Terminal box type (Small)

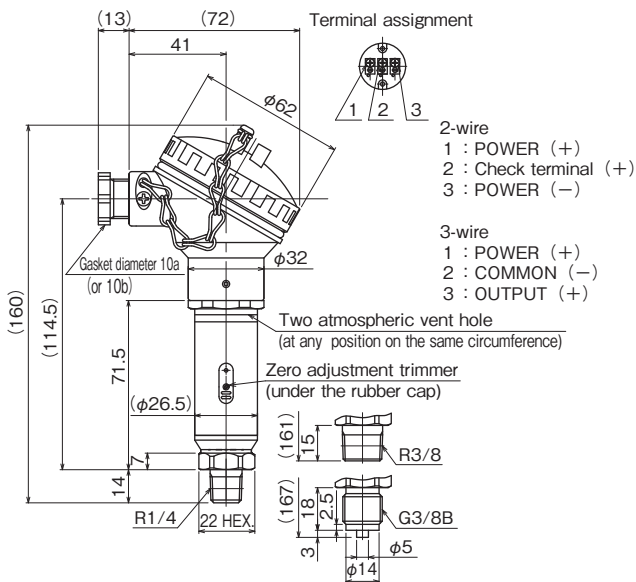

#### Terminal box type (Large)

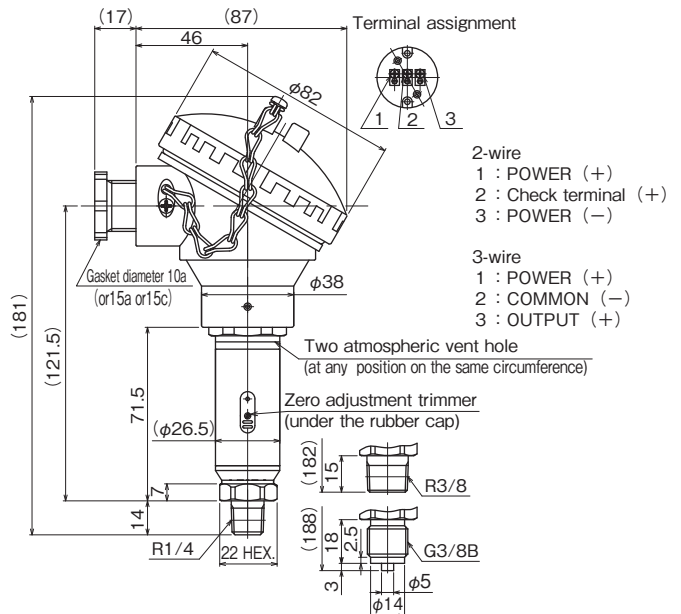

### Model number configuration

Please specify the model number, each specs and the range for ordering.

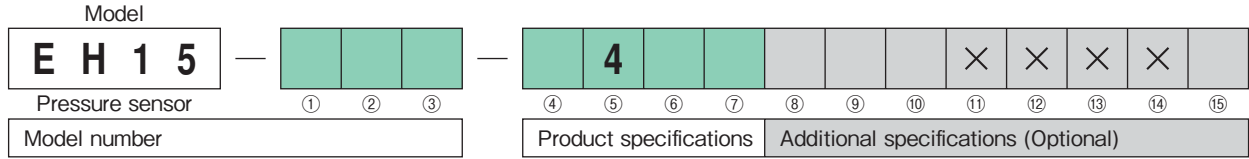

① Model	M	M12 connector cable (Cable with M12 connector sold separately)	8	Cable type (with 2m shielded cable)
	2	DIN connector cable	9	Terminal box type (large)
② Connection thread	3	G3/8B	Available only for ranges up to 50MPa	
	7	R1/4		
	8	R3/8		
Other specifications (please contact us).				
③ Wetted parts material	4	Diaphragm: SUS630 (17-4PH), Fitting: SUS304 Medium-to-high gauge pressure range		
	8	Diaphragm: SUS316L, Fitting: SUS316L Absolute / low gauge pressure (Liquid-filled: silicone oil)		

After selecting the range code, please specify the pressure range and unit separately.

④ Pressure range	Low pressure/Absolute pressure (Wetted parts material code: 8)		Medium/High pressure (Wetted parts material code: 4)	
	1	-20 to 20kPa (Compound range)	E	-0.1 to 0.5MPa (Compound range)
	2	-50 to 50kPa (Compound range)	F	-0.1 to 1MPa (Compound range)
	3	-100 to 100kPa (Compound range)	G	-0.1 to 2MPa (Compound range)
	4	-100 to 200kPa (Compound range)	H	0 to 0.5MPa
	5	-100 to 300kPa (Compound range)	J	0 to 1MPa
	6	-100 to 0kPa (Vacuum range)	K	0 to 2MPa
	7	0 to 35kPa	L	0 to 3.5MPa
	8	0 to 50kPa	M	0 to 5MPa
	A	0 to 100kPa	N	0 to 10MPa
	B	0 to 200kPa	P	0 to 20MPa
	C	0 to 300kPa	Q	0 to 35MPa
	D	0 to 120kPa abs. (Absolute pressure)	R	0 to 50MPa
			S	0 to 70MPa
		T	0 to 100MPa	
		U	0 to 150MPa	

⑤ Accuracy	4	±0.25%F.S.
------------	---	------------

⑥ Power supply	C	12 to 36V DC
	R	15 to 36V DC (Only 0 to 10V DC)

※ Option (sold separately): Cable with M12 connector

Types of cables with M12 connectors		
PUR cable (oil-resistant)	Straight	Cable length 2m
	Right-angle	
PVC cable (stainless nut)	Straight	Cable length 2m
	Right-angle	
PUR cable (oil-resistant)	Straight	Cable length 5m
	Right-angle	
PVC cable (stainless nut)	Straight	Cable length 5m
	Right-angle	

⑦ Output	1	4 to 20mA DC (2-wire)
	6	0 to 5V DC (3-wire)
	7	0 to 10V DC (3-wire)
	8	1 to 5V DC (3-wire)

⑧ Outlet for electric wire ⑨ Cable type			⑧ Outlet for electric wire	⑨ Cable type
	M12 connector type, DIN connector type			
	0	0	—	None (Pressure sensor only)
	Cable type (Cable length: 2m unless otherwise specified) Note:1			
	0	B	—	Heat-resistant cable
	0	C	—	Cold-resistant cable (Standard)
	Terminal box (small) (no attached cable)			
	1	0	10a (Standard)	—
	2	0	10b (Standard)	—
	Terminal box (large) (no attached cable)			
3	0	15a	—	
4	0	15b (Standard)	—	
5	0	15c	—	

Note:1

[When specifying a cable length of 2m or more]

- For voltage output, cable lengths up to 5m are supported.
- For current output, cable lengths up to 20m are supported.

#### Treatment for wetted parts

##### ■ Use no oil

Any oil used during gauge manufacturing has been thoroughly flushed out, and no oil residue remains in the wetted parts.

##### ■ Use no water

Any water used during manufacturing has been removed, and no water residue remains in the wetted parts.

##### ■ Use no oil & water

Any oil or water used during manufacturing has been removed, and no oil or water residue remains in the wetted parts.

⑩ Treatment	0	Not required
	1	Use no oil
	2	Use no water
	3	Use no oil & water
⑮ Documents	0	Not required
	1	Required (Please specify separately.) Data sheet (Drawing/Specifications) Instruction manual Inspection report (one copy per item) Inspection and Traceability Certificate

\* Specify code "X" to refer N/A

# EH15

Pressure Sensor

## Low-pressure hydrogen

Unit: mm

### Dimensions 2

#### M12 connector type

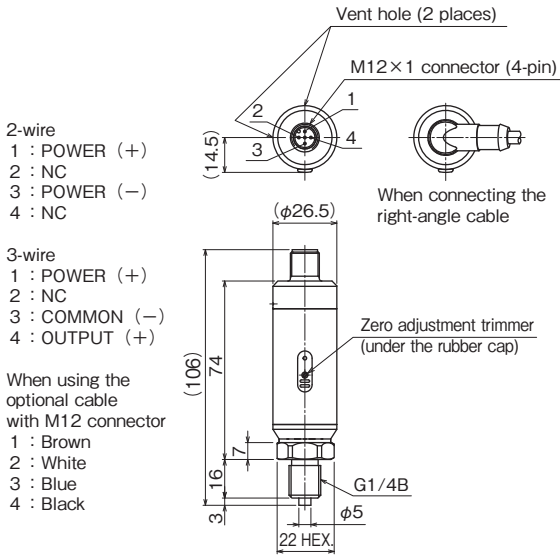

#### Terminal box type (small)

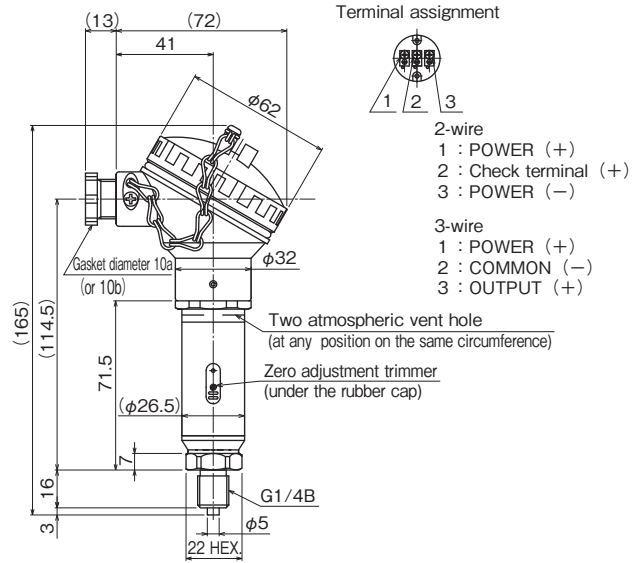

### Enhanced safety in hydrogen measurement compared with sealed types!

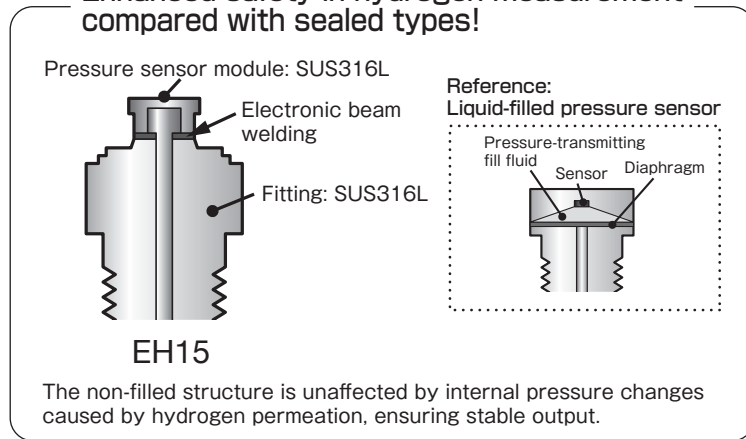

### Application

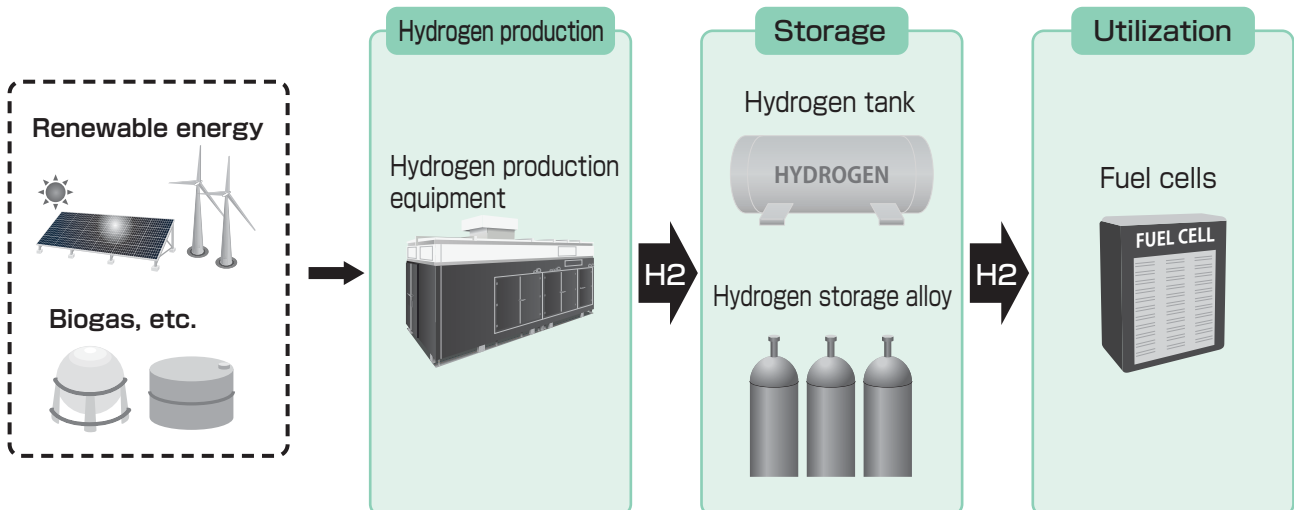

# EH15

## Pressure Sensor

### Low-pressure hydrogen

#### Model number configuration

Please specify the model number, each specs and the range for ordering.

Model

<b>E H 1 5</b>	—	<b>2 G</b>	—	<b>4 C</b>	<b>0 3</b>	<b>×</b>	<b>×</b>	<b>×</b>		
		① ② ③		④ ⑤ ⑥ ⑦	⑧ ⑨ ⑩	⑪	⑫	⑬	⑭	⑮

Low-pressure hydrogen Pressure sensor

Model number	Product specifications	Additional specifications (Optional)																
① Model	M M12 connector cable (Cable with M12 connector sold separately)  7 Terminal box type (small)																	
② Connection thread	2 G1/4B																	
③ Wetted parts material	G Pressure sensor: SUS316L, Fitting: SUS316L																	
④ Pressure range ⑤ Accuracy	<table border="1" style="width: 100%; border-collapse: collapse;"> <tr> <td style="width: 10%; text-align: center;">④</td> <td style="width: 10%; text-align: center;">⑤</td> <td style="width: 60%;">④ Pressure range</td> <td style="width: 20%;">⑤ Accuracy</td> </tr> <tr> <td style="text-align: center;">C</td> <td style="text-align: center;">4</td> <td>0 to 0.3MPa</td> <td rowspan="2" style="text-align: center;">±0.25%F.S. at 23°C</td> </tr> <tr> <td style="text-align: center;">J</td> <td style="text-align: center;">4</td> <td>0 to 1MPa</td> </tr> </table>	④	⑤	④ Pressure range	⑤ Accuracy	C	4	0 to 0.3MPa	±0.25%F.S. at 23°C	J	4	0 to 1MPa						
④	⑤	④ Pressure range	⑤ Accuracy															
C	4	0 to 0.3MPa	±0.25%F.S. at 23°C															
J	4	0 to 1MPa																
⑥ Power supply	C 12 to 36V DC																	
⑦ Analog output	<table border="1" style="width: 100%; border-collapse: collapse;"> <tr> <td style="width: 10%; text-align: center;">1</td> <td style="width: 90%;">4 to 20mA DC (2-wire)</td> </tr> <tr> <td style="text-align: center;">8</td> <td>1 to 5V DC (3-wire)</td> </tr> </table>	1	4 to 20mA DC (2-wire)	8	1 to 5V DC (3-wire)													
1	4 to 20mA DC (2-wire)																	
8	1 to 5V DC (3-wire)																	
⑧ Outlet for electric ⑨ Cable type	<table border="1" style="width: 100%; border-collapse: collapse;"> <tr> <td style="width: 10%; text-align: center;">⑧</td> <td style="width: 10%; text-align: center;">⑨</td> <td style="width: 40%;">⑧ Outlet for electric</td> <td style="width: 40%;">⑨ Cable type</td> </tr> <tr> <td style="text-align: center;">0</td> <td style="text-align: center;">0</td> <td>—</td> <td>None (Pressure sensor only)</td> </tr> <tr> <td style="text-align: center;">1</td> <td style="text-align: center;">0</td> <td>10a (Standard)</td> <td>—</td> </tr> <tr> <td style="text-align: center;">2</td> <td style="text-align: center;">0</td> <td>10b</td> <td>—</td> </tr> </table>	⑧	⑨	⑧ Outlet for electric	⑨ Cable type	0	0	—	None (Pressure sensor only)	1	0	10a (Standard)	—	2	0	10b	—	
⑧	⑨	⑧ Outlet for electric	⑨ Cable type															
0	0	—	None (Pressure sensor only)															
1	0	10a (Standard)	—															
2	0	10b	—															
⑩ Treatment	3 Use no oil & water																	
⑭ Measured fluid	<table border="1" style="width: 100%; border-collapse: collapse;"> <tr> <td style="width: 10%; text-align: center;">0</td> <td style="width: 90%;">Not required</td> </tr> <tr> <td style="text-align: center;">A</td> <td>Ammonia</td> </tr> <tr> <td style="text-align: center;">H</td> <td>Hydrogen</td> </tr> </table>	0	Not required	A	Ammonia	H	Hydrogen											
0	Not required																	
A	Ammonia																	
H	Hydrogen																	
⑮ Documents	<table border="1" style="width: 100%; border-collapse: collapse;"> <tr> <td style="width: 10%; text-align: center;">0</td> <td style="width: 90%;">Not required</td> </tr> <tr> <td style="text-align: center;">1</td> <td>Required (Please specify separately.) Data sheet (Drawing/Specifications) Instruction manual Inspection report (one copy per item) Inspection and Traceability Certificate</td> </tr> </table>	0	Not required	1	Required (Please specify separately.) Data sheet (Drawing/Specifications) Instruction manual Inspection report (one copy per item) Inspection and Traceability Certificate													
0	Not required																	
1	Required (Please specify separately.) Data sheet (Drawing/Specifications) Instruction manual Inspection report (one copy per item) Inspection and Traceability Certificate																	

After selecting the range code, please specify the pressure range and unit separately.

※ Option (sold separately): Cable with M12 connector

Types of cables with M12 connectors		
PUR cable (oil-resistant)	Straight	Cable length 2m
	Right-angle	
PVC cable (stainless nut)	Straight	Cable length 2m
	Right-angle	
PUR cable (oil-resistant)	Straight	Cable length 5m
	Right-angle	
PVC cable (stainless nut)	Straight	Cable length 5m
	Right-angle	

\* Specify code "X" to refer N/A

# EH15

## Pressure Sensor

### Marine

### Dimensions 3

- 2-wire  
 1 : POWER (+)  
 2 : NC  
 3 : POWER (-)  
 4 : NC

When using the optional cable with M12 connector

- 1 : Brown  
 2 : White  
 3 : Blue  
 4 : Black

Atmospheric vent hole

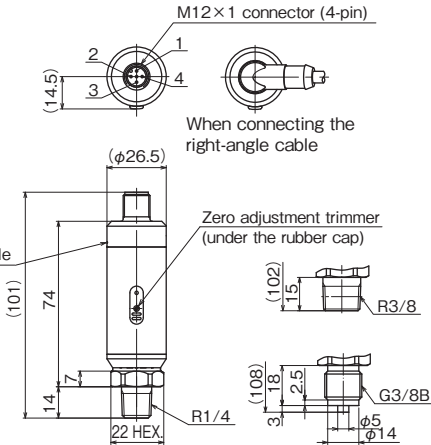

### Marine standards

NK Rules (Automation Equipment and System)  
 Type Approval No.: 25A003

### Application

Tank level measurement

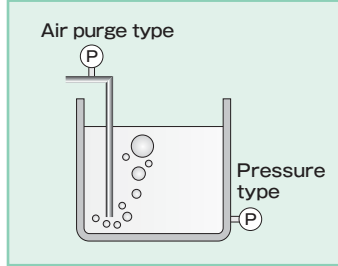

Ballast water treatment system

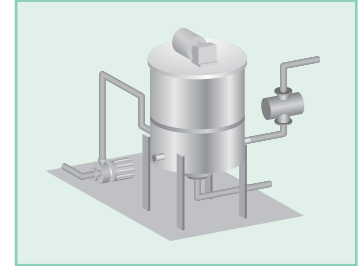

### Model number configuration

Please specify the model number, each specs and the range for ordering.

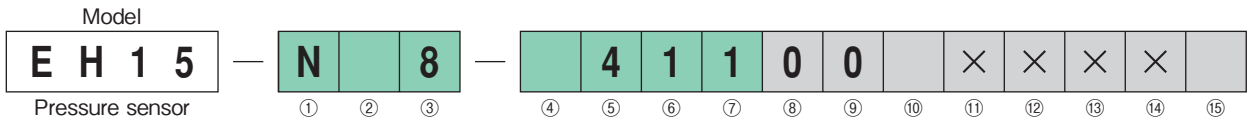

Model number	Product specifications	Additional specifications (Optional)																																																																																																												
<table border="1" style="width: 100%; border-collapse: collapse;"> <tr> <td style="width: 10%;">① Model</td> <td style="width: 10%; text-align: center;"><b>N</b></td> <td style="width: 80%;">NK certification</td> </tr> <tr> <td rowspan="3">② Connection thread</td> <td style="text-align: center;"><b>3</b></td> <td>G3/8B</td> </tr> <tr> <td style="text-align: center;"><b>7</b></td> <td>R1/4</td> </tr> <tr> <td style="text-align: center;"><b>8</b></td> <td>R3/8</td> </tr> <tr> <td colspan="2"></td> <td>Other specifications (please contact us).</td> </tr> <tr> <td>③ Wetted parts material</td> <td style="text-align: center;"><b>8</b></td> <td>Diaphragm: SUS316L, Fitting: SUS316L Liquid-filled: silicone oil</td> </tr> </table>	① Model	<b>N</b>	NK certification	② Connection thread	<b>3</b>	G3/8B	<b>7</b>	R1/4	<b>8</b>	R3/8			Other specifications (please contact us).	③ Wetted parts material	<b>8</b>	Diaphragm: SUS316L, Fitting: SUS316L Liquid-filled: silicone oil	<table border="1" style="width: 100%; border-collapse: collapse;"> <tr> <td rowspan="6">④ Pressure range</td> <td style="text-align: center;"><b>1</b></td> <td>-20 to 20kPa (Compound range)</td> <td style="text-align: center;"><b>7</b></td> <td>0 to 35kPa</td> </tr> <tr> <td style="text-align: center;"><b>2</b></td> <td>-50 to 50kPa (Compound range)</td> <td style="text-align: center;"><b>8</b></td> <td>0 to 50kPa</td> </tr> <tr> <td style="text-align: center;"><b>3</b></td> <td>-100 to 100kPa (Compound range)</td> <td style="text-align: center;"><b>A</b></td> <td>0 to 100kPa</td> </tr> <tr> <td style="text-align: center;"><b>4</b></td> <td>-100 to 200kPa (Compound range)</td> <td style="text-align: center;"><b>B</b></td> <td>0 to 200kPa</td> </tr> <tr> <td style="text-align: center;"><b>5</b></td> <td>-100 to 300kPa (Compound range)</td> <td style="text-align: center;"><b>C</b></td> <td>0 to 300kPa</td> </tr> <tr> <td style="text-align: center;"><b>6</b></td> <td>-100 to 0kPa (Vacuum range)</td> <td></td> <td></td> </tr> <tr> <td>⑤ Accuracy</td> <td style="text-align: center;"><b>4</b></td> <td colspan="3">±0.25%F.S. (at 23±2°C)</td> </tr> <tr> <td>⑥ Power supply</td> <td style="text-align: center;"><b>1</b></td> <td colspan="3">24V DC ±10%</td> </tr> <tr> <td>⑦ Output</td> <td style="text-align: center;"><b>1</b></td> <td colspan="3">4 to 20mA DC (2-wire)</td> </tr> <tr> <td colspan="2"></td> <td colspan="3">Other specifications (please contact us).</td> </tr> <tr> <td rowspan="2">⑧ Outlet for electric wire</td> <td style="text-align: center;">⑧</td> <td style="text-align: center;">⑨</td> <td colspan="2">⑧ Outlet for electric wire</td> </tr> <tr> <td style="text-align: center;">0</td> <td style="text-align: center;">0</td> <td colspan="2">M12 connector type</td> </tr> <tr> <td>⑨ Cable type</td> <td colspan="2"></td> <td colspan="2">⑨ Cable type</td> </tr> <tr> <td colspan="2"></td> <td colspan="2"></td> <td>None (Pressure sensor only)</td> </tr> <tr> <td colspan="2"></td> <td rowspan="3">⑩ Treatment</td> <td style="text-align: center;">0</td> <td>Not required</td> </tr> <tr> <td colspan="2"></td> <td style="text-align: center;">1</td> <td>Use no oil</td> </tr> <tr> <td colspan="2"></td> <td style="text-align: center;">2</td> <td>Use no water</td> </tr> <tr> <td colspan="2"></td> <td style="text-align: center;">3</td> <td colspan="2">Use no oil &amp; water</td> </tr> <tr> <td colspan="2"></td> <td rowspan="2">⑮ Documents</td> <td style="text-align: center;">0</td> <td>Not required</td> </tr> <tr> <td colspan="2"></td> <td style="text-align: center;">1</td> <td colspan="2">Required (Please specify separately.) Data sheet (Drawing/Specifications) Instruction manual Inspection report (one copy per item) Inspection and Traceability Certificate</td> </tr> </table>	④ Pressure range	<b>1</b>	-20 to 20kPa (Compound range)	<b>7</b>	0 to 35kPa	<b>2</b>	-50 to 50kPa (Compound range)	<b>8</b>	0 to 50kPa	<b>3</b>	-100 to 100kPa (Compound range)	<b>A</b>	0 to 100kPa	<b>4</b>	-100 to 200kPa (Compound range)	<b>B</b>	0 to 200kPa	<b>5</b>	-100 to 300kPa (Compound range)	<b>C</b>	0 to 300kPa	<b>6</b>	-100 to 0kPa (Vacuum range)			⑤ Accuracy	<b>4</b>	±0.25%F.S. (at 23±2°C)			⑥ Power supply	<b>1</b>	24V DC ±10%			⑦ Output	<b>1</b>	4 to 20mA DC (2-wire)					Other specifications (please contact us).			⑧ Outlet for electric wire	⑧	⑨	⑧ Outlet for electric wire		0	0	M12 connector type		⑨ Cable type			⑨ Cable type						None (Pressure sensor only)			⑩ Treatment	0	Not required			1	Use no oil			2	Use no water			3	Use no oil & water				⑮ Documents	0	Not required			1	Required (Please specify separately.) Data sheet (Drawing/Specifications) Instruction manual Inspection report (one copy per item) Inspection and Traceability Certificate		<p>After selecting the range code, please specify the pressure range and unit separately.</p>
① Model	<b>N</b>	NK certification																																																																																																												
② Connection thread	<b>3</b>	G3/8B																																																																																																												
	<b>7</b>	R1/4																																																																																																												
	<b>8</b>	R3/8																																																																																																												
		Other specifications (please contact us).																																																																																																												
③ Wetted parts material	<b>8</b>	Diaphragm: SUS316L, Fitting: SUS316L Liquid-filled: silicone oil																																																																																																												
④ Pressure range	<b>1</b>	-20 to 20kPa (Compound range)	<b>7</b>	0 to 35kPa																																																																																																										
	<b>2</b>	-50 to 50kPa (Compound range)	<b>8</b>	0 to 50kPa																																																																																																										
	<b>3</b>	-100 to 100kPa (Compound range)	<b>A</b>	0 to 100kPa																																																																																																										
	<b>4</b>	-100 to 200kPa (Compound range)	<b>B</b>	0 to 200kPa																																																																																																										
	<b>5</b>	-100 to 300kPa (Compound range)	<b>C</b>	0 to 300kPa																																																																																																										
	<b>6</b>	-100 to 0kPa (Vacuum range)																																																																																																												
⑤ Accuracy	<b>4</b>	±0.25%F.S. (at 23±2°C)																																																																																																												
⑥ Power supply	<b>1</b>	24V DC ±10%																																																																																																												
⑦ Output	<b>1</b>	4 to 20mA DC (2-wire)																																																																																																												
		Other specifications (please contact us).																																																																																																												
⑧ Outlet for electric wire	⑧	⑨	⑧ Outlet for electric wire																																																																																																											
	0	0	M12 connector type																																																																																																											
⑨ Cable type			⑨ Cable type																																																																																																											
				None (Pressure sensor only)																																																																																																										
		⑩ Treatment	0	Not required																																																																																																										
			1	Use no oil																																																																																																										
			2	Use no water																																																																																																										
		3	Use no oil & water																																																																																																											
		⑮ Documents	0	Not required																																																																																																										
			1	Required (Please specify separately.) Data sheet (Drawing/Specifications) Instruction manual Inspection report (one copy per item) Inspection and Traceability Certificate																																																																																																										

※ Option (sold separately): Cable with M12 connector

Types of cables with M12 connectors		
PUR cable (oil-resistant)	Straight	Cable length 2m
	Right-angle	
PVC cable (stainless nut)	Straight	Cable length 2m
	Right-angle	
PUR cable (oil-resistant)	Straight	Cable length 5m
	Right-angle	
PVC cable (stainless nut)	Straight	Cable length 5m
	Right-angle	

\* Document only indicates presence or absence, and please specify the content separately.

\* Specify code "X" to refer N/A