

# DG12

## Small Differential Pressure Gauge

### Overview

This sealed type small pressure gauge features high pressure and low pressure connection to detect differential pressure by deformation of incorporated bourdon tube.

### Features

Designed for small and lightweight for easy-to-use for non-corrosive gases measurements including air and N<sub>2</sub> for applications like typical filter clogging etc.



### Specifications

**Media:**

Compatible with wetted parts  
(Process gases should contain no dust or dirt)

**Construction:**

Sealed type

**Mounting method:**

Stem

**Size:**

φ 70 (Case diameter)

**Pressure connection:**

R1/4 (High pressure) · Rc1/4 (Low pressure) or  
1/4NPT Male (High pressure) · 1/4NPT Female (Low pressure)

**Wetted parts:**

Copper alloy, aluminum alloy, zinc alloy,  
inorganic window, NBR

**Differential pressure range:**

0 to 0.1 → 0 to 0.2MPa

**Reference pressure:**

1.5MPa and below

**Proof pressure for enclosure:**

1.5MPa and below

**Operating temperature:**

-5 to 45°C

**Accuracy:**

±3%F.S.

**Dial scale angle:**

270°

**Case finish:**

Black

**Weight:**

Approx. 0.5kg

# DG12

## Small Differential Pressure Gauge

### Dimensions

Unit: mm

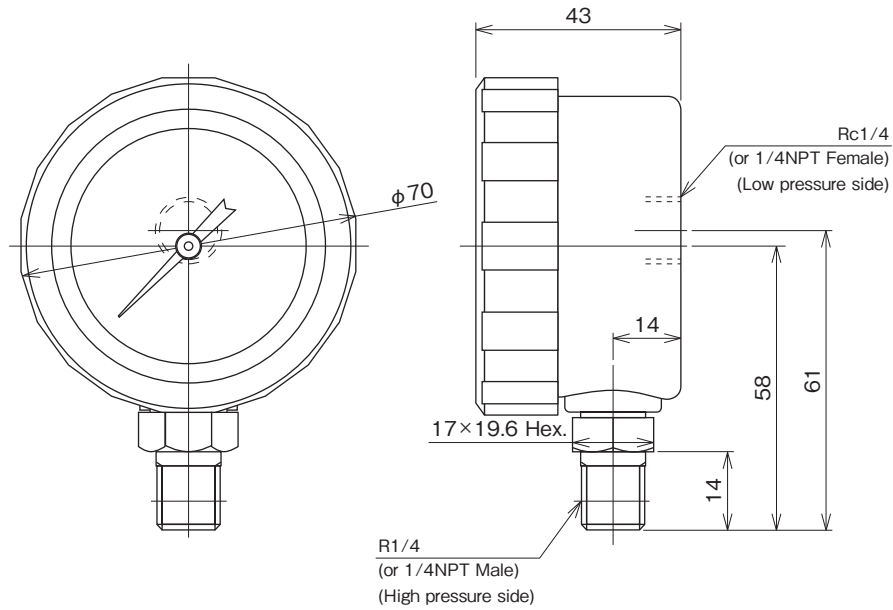

### Model number configuration

Please specify the model, each requiring specification and differential pressure range to order.

Model			Small Differential Pressure Gauge													
Model number			Product specifications						Additional specifications (Optional)							
D	G	12	1		1	X	X	X	X	X	X	X	X	X	X	
①	Type	1	②	Connection	2	③	Wetted parts	1	④	Differential pressure range	1	⑤	Documents	0	⑥	⑦
Type		1	Type													
Connection		2	R1/4 (High pressure side), Rc1/4 (Low pressure side)													
Connection		3	1/4NPT Male (High pressure side), 1/4NPT Female (Low pressure side)													
Wetted parts		1	Copper alloy, aluminum alloy, zinc alloy, inorganic window, NBR													
Differential pressure range		1	0 to 0.1, 0.15, 0.2MPa													
Documents		0	Not required													
Documents		1	Required (Documents available upon request) Datasheet (Drawing / Specifications) Instruction manual Attending inspection													

[Scope of manufacturing]  
·Reference pressure: 1.5MPa and below

\* Specify code "X" to refer N/A